

# C.CRANE

## CCPOCKET



## INSTRUCTION MANUAL

PLEASE READ ALL THE INSTRUCTIONS COMPLETELY BEFORE USE  
AND SAVE THIS MANUAL FOR FUTURE REFERENCE



## Owners Record

---

### CAUTION:

- Before turning the unit on, set your volume control to a low setting.
- Slowly increase the sound until you can hear it comfortably and clearly without distortion.
- Long-term exposure to loud sounds may cause hearing damage. It is best to avoid high volume levels when using headphones/earbuds, especially for extended periods.

### For your future reference:

Serial No. (Found inside battery compartment): \_\_\_\_\_

Date of purchase / Name & address of dealer: \_\_\_\_\_

\_\_\_\_\_

### Unpacking

The box should contain the CC Pocket Radio, earbuds, FM wire antenna, and this manual. If anything is missing or damaged please contact C. Crane immediately. We recommend you keep the box in the unlikely event your radio needs to be serviced.

The CC Pocket radio uses the latest in digital chip technology along with our own techniques developed at C. Crane. It is able to bring in a weak FM station better than perhaps any other pocket radio. The button layout is easy to understand for basic use. It is different than other radios because some of the features can be changed by reading the manual and using multiple button presses to change them.

On AM, overload from a strong local station has been a problem since the dawn of radio. The CC Pocket may be able to shut out the offending station perhaps like no other radio you have owned.

If you have any question about your radio, please give us a call or check out: [ccrane.com](http://ccrane.com).

### **READ BEFORE OPERATING EQUIPMENT. SAVE THESE INSTRUCTIONS.**

- 1.) Read and understand all safety and operating instructions before the radio is operated.
- 2.) **Heat:** Never put the radio in direct sunlight in an unventilated area or behind glass like a car's interior. The appliance should be away from heat sources such as radiators, heat registers, stoves, or other appliances that produce heat.
- 3.) If the radio is left unattended and unused for long periods of time, remove the batteries. The batteries may leak and damage furniture or your radio.
- 4.) The user should not attempt to service the appliance beyond that described in the operating instructions. All other servicing should be referred to qualified service personnel.

## Table of Contents

---

Owners Record.....	3
Introduction/Safety Instructions.....	4
Installing the Batteries .....	6
Display Screen Identification .....	7
Power Button/Sleep Timer .....	8
Earphone Jack/External FM Antenna.....	8
Setting the Volume .....	8
Tuning Buttons .....	8
Saving a Station to Memory .....	8
Listening with Speaker .....	8
Change Bands and Memory Pages.....	9
Changing Display/Weather Alert.....	9
Lock Switch .....	9
Earphone/ Speaker Switch .....	10
Removing the Belt Clip .....	10
Battery Compartment.....	10
Setting the Clock.....	11
Setting the Alarm .....	11
Disable Beep Sound .....	12
Designate Frequency or Clock While Listening .....	12
Activate 9 or 10 kHz AM Tuning .....	13
Disable the Display for Better Reception .....	13
Activate 1 kHz AM Tuning Steps .....	13
Activate Narrow AM Filters .....	13
Reset to Factory Defaults.....	13
<b>Troubleshooting Guide .....</b>	<b>14</b>
Specifications .....	16

### INSTALLING THE BATTERIES

- 1.) Position the radio face down on a soft surface to protect it.
- 2.) Remove the battery cover using your fingernail or small tool. Press and lift the area indicated below.

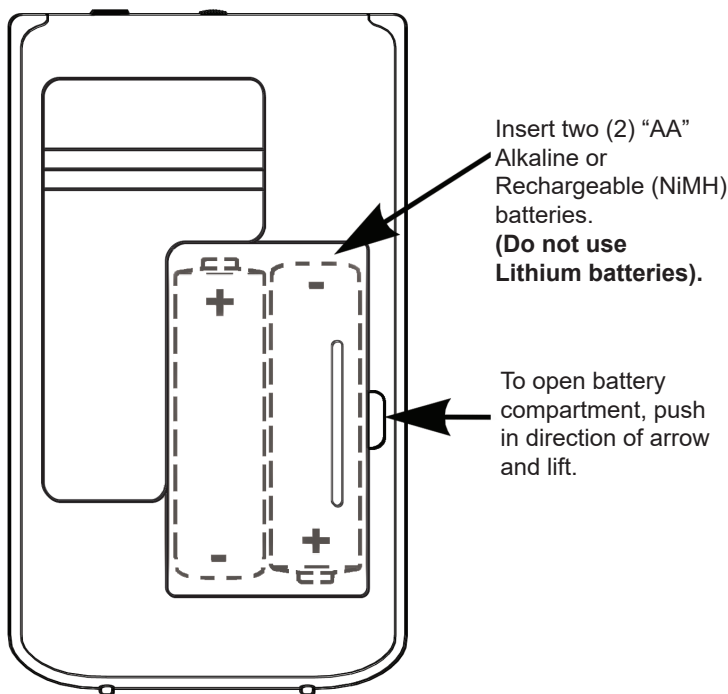

- 3.) Insert the two (2) "AA" Alkaline or Rechargeable (NiMH) batteries into the compartment as indicated. **(Do not use Lithium batteries).** Be sure the negative (-) end of each battery is against the spring.
- 4.) Replace the battery cover. You are now ready to operate your radio.

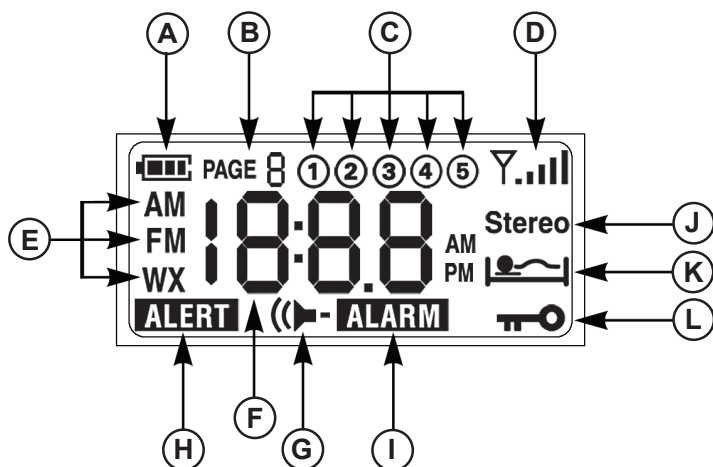

- A. Battery Icon
- B. Page number (for station memories)
- C. Station memories 1 - 5
- D. Reception Signal Strength
- E. Band Indicator (AM, FM, Weather)
- F. Frequency/Time
- G. Speaker is Activated
- H. Alert is Activated
- I. Alarm is Activated
- J. Stereo FM Reception
- K. Sleep Timer is Activated
- L. Lock Switch is Activated (buttons are disabled)

### Top View

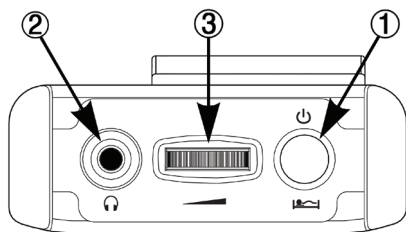

#### **1. Power Button / Sleep Timer**

To turn the radio "ON" just press the red button. To use the Sleep Timer, press and hold the red button. The Sleep Timer will automatically shut off the radio after the set amount of time expires. The display will cycle through minutes 90, 60, 30, 15, 120, and OFF. Release the power button to activate the sleep setting you desire. The radio will remember your last Sleep Timer setting the next time you activate it.

#### **2. Earphone Jack / External FM Antenna Jack**

To listen using earphones, adjust the switch on the left side of the radio to "Stereo" or "Mono" position. When earphones are plugged in, they become an external antenna for FM, even when the side switch is in speaker mode. The included external FM wire antenna will also connect to this jack for even better reception in speaker mode.

#### **3. Volume Control**

Rotate to adjust volume.

#### **4. Tuning Buttons (See Illustration Page 9)**

Press once quickly to tune to the next frequency increment. Press and hold for 1-second to automatically tune to the next strong station. Hold continuously to cycle through the whole band.

#### **5. Station Memory Buttons 1-5 (See Illustration Page 9)**

Save your favorite stations to memory buttons. To save a station, press and hold any memory button for 2-seconds while the station is playing. To play a saved station, press the same button once quickly. See page 9 for secondary functions.

#### **6. Speaker (See Illustration Page 9)**

To enable speaker, adjust the switch on the left side of the radio to the "Speaker" position. The Speaker icon will show on the display.



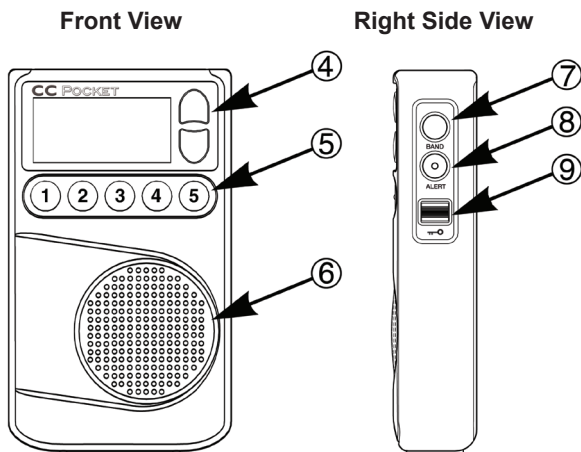

### 7. Change Bands and Memory Pages

Press and release the BAND button to cycle between FM, AM, and Weather. The BAND button can also be used to access station memory pages. This gives you 20 additional presets each for AM and FM. Press and hold the BAND button for 2 seconds to change page numbers, press any memory button 1-5 to select the Page number that you desire. Each page can hold five additional station memories.

### 8. Change Display / Weather Alert Button

While listening to the radio, press the ALERT button once to view the frequency or time. To activate the NOAA Weather Alert, press and hold this button for more than 3 seconds. Continue holding to select how long the alert will be activated for (4hr, 8hr, and 16hr). Release the button to make your selection. While weather alert is activated, AM and FM will be disabled because of chip limitations. The display light will flash once every few seconds to remind you that the NOAA Weather Alert is "ON". To turn the alert "OFF", hold the ALERT button for three seconds until "OFF" is displayed and beep is heard, then release the button.

### 9. Lock Switch

Slide the switch up to disable all buttons. Slide the switch down to enable all buttons.

### 10. Earphone/ Speaker Switch

Stereo (Top Position) - This position is for listening to FM Stereo radio using headphones. While in this position, the speaker will be disabled. AM and WX bands will play normally.

Mono (Middle Position) - This position is for listening to FM Mono radio using headphones. Typically, FM Mono will have better reception than FM Stereo.

Speaker (Bottom Position) - This position is for listening to AM, FM, or WX using the speaker. While in this position, the headphone jack will be disabled.

### 11. Belt Clip

To remove the belt clip unscrew the two screws on the back of the clip.

### 12. Battery Compartment

Requires two (2) "AA" Alkaline or Rechargeable (NiMH) batteries.

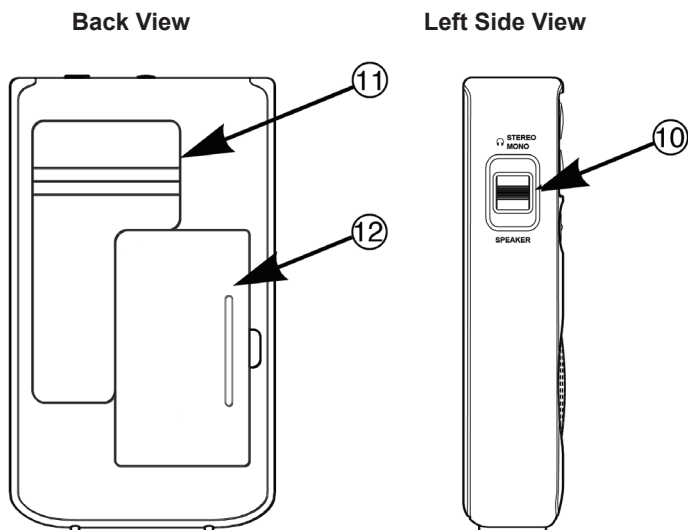

## Radio Setup

---

### Setting the Clock

1. With the power OFF, press and hold memory button #1 for two seconds. Release.
2. While the Hour is flashing, press the Up or Down Tuning buttons until the hour and AM/PM time is correct.
3. Press and release memory button #1 to adjust the minutes. Cycle minutes using the Up or Down Tuning buttons.
4. Press and release memory button #1 again after the time is set correctly.

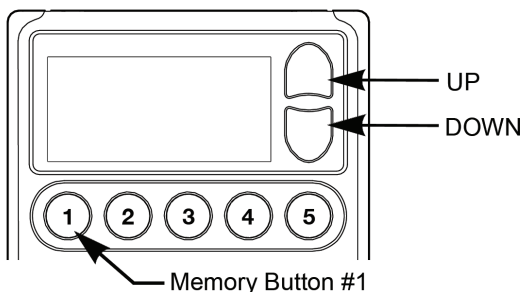

### Setting the Alarm

1. With the power OFF, press and hold memory button #2 for two seconds. Release.
2. While the Hour is flashing, press the Up or Down Tuning buttons until the hour and AM/PM time is correct.
3. Press and release memory button #2 to adjust the minutes. Cycle minutes using the Up or Down Tuning buttons.
4. Press and release memory button #2 again after the time is set correctly. To disable the alarm, press and hold memory button #2 for two seconds.

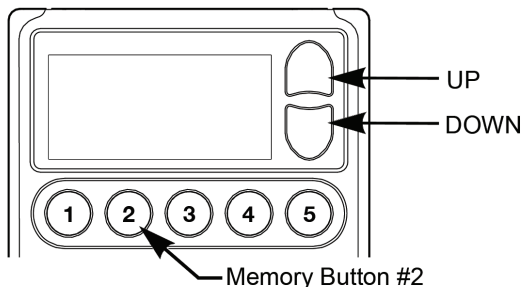

## Radio Setup

---

### Disable Beep Sound

1. With the power OFF, press and hold memory button #3 for two seconds. All beeps are disabled except ALARM and WX ALERT.
2. Repeat sequence to enable beep again.

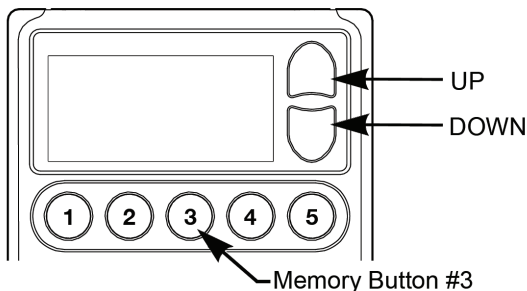

### Designate Frequency or Clock while Listening to the Radio

1. With the power OFF, press and hold memory button #4 for two seconds. "C" will appear on the screen indicating that the Clock will show while listening to radio.
2. Repeat sequence to display Frequency instead. "F" will appear on the screen to indicate that the Frequency will show when listening to the radio.

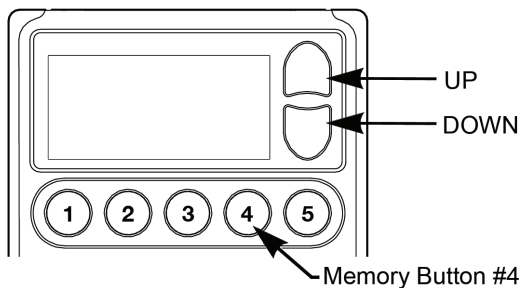

## Radio Setup

---

### Activate 9 or 10 kHz AM Tuning (also expands FM band)

1. With the power OFF, press and hold memory button #5 for two seconds to activate 9 kHz AM tuning mode. This will also expand the FM band from 76 MHz to 108 MHz.
2. Repeat sequence to switch back to 10 kHz AM tuning and regular FM coverage.

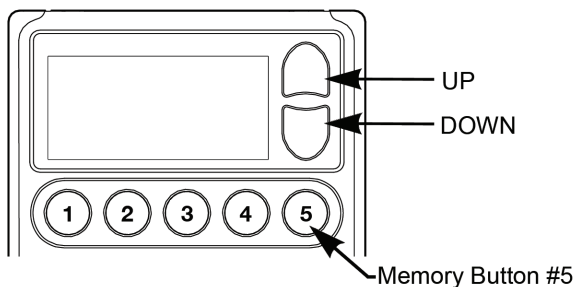

### Disable Display Screen

Quickly press memory buttons #1 and #5 at the same time while listening to your desired AM station. **Note:** This is used to improve AM radio reception. Once activated, if any button is pressed, the display screen will turn “ON” again. To keep display OFF after disabling, we recommend setting the lock switch. See page 9.

### Activate 1 kHz AM Tuning Steps

Quickly press memory buttons #1 and #4 at the same time while listening to your desired AM station. Press again to return to normal (10 kHz) tuning. **Note:** This setting can tune AM stations that are slightly off frequency for various reasons. Tuning 1 kHz higher or lower than the actual station frequency may help improve reception.

### Activate Narrow AM Filters

Quickly press memory buttons #1 and #3 at the same time while listening to your desired AM station. Press again to return to normal (wide) tuning. **Note:** This setting is helpful to eliminate unwanted noise or adjacent overlapping stations. Narrow AM (2.5 kHz) may work best for voice. The normal setting (4 kHz) is best for music.

### Reset to Factory Defaults

With power OFF, press and hold memory buttons #1 and #5 until you hear 4 beeps, a pause and two more beeps.

### **The CC Pocket will not turn on and none of the buttons work:**

The Lock Switch, located on the right side of the radio under the ALERT button, is in the up position. Push the switch down to release the lock and resume normal operation of the radio. (Please see Lock Switch on page 9.)

### **My radio shuts off after just a few seconds:**

Low batteries can cause this situation. Replace them with a new set of batteries.

### **Stations won't hold in memory:**

The memory button settings are being overwritten. When recalling a station from memory, if you hold the memory button down too long it will program the current station over your previously stored station. To recall a station that has been stored in memory, always press and release the button quickly. To program a new station into memory, tune to the desired station and then press and hold the memory button for two seconds until you hear a beep.

### **The AM reception is poor:**

You may need to rotate your pocket radio until the reception is best. Many buildings that use brick, metal, or stucco can absorb or reflect the AM signal. Computers and other electronic equipment, including fluorescent lights, can cause noise that interferes with your AM reception. Move the radio to a different place to see if that helps. Additional noise may affect a weak signal. See page 13 for radio settings that may improve your AM reception.

### **Poor reception on FM and Weather band:**

The CC Pocket can use its internal antenna, the included external wire antenna, or headphones as an antenna for FM and the Weather bands. To improve reception of these bands, try various orientations of the headphone or antenna wire to obtain the strongest signal.

### **Battery Power Level Indicator doesn't show full charge when using rechargeable batteries:**

Rechargeable batteries will not show a full charge on your radios display. The CC Pocket is calibrated to read the charge of your alkaline batteries, which is 1.5 volts at full charge.

Rechargeable batteries, however, are fully charged at just 1.25 volts, and so your radio will show a partial charge even if the rechargeable batteries have been fully charged. We do not recommend using Lithium batteries in our products.

### **My radio is stuck on the Weather Band and I can't change to FM or AM:**

The Weather Alert has been activated. Turn the Weather Alert off by holding the ALERT button for three seconds until "OFF" is displayed. See page 9. Then press and release the BAND button to change to FM or AM.

### **My radio was working on AM but now it will not tune to my favorite AM station clearly:**

It is possible that the tuning step has been changed from 10 kHz (used in the US) to 9 kHz (used in other countries such as the UK) tuning. To change this back to 10 kHz, turn radio off. Press and hold the number #5 memory button down for 3 seconds until 10 is displayed. See page 13.

### **The radio is turned on but there is no audio coming from the speaker:**

Check the switch on the left side of the radio and make sure the switch is down and set to Speaker. If the switch was up, the radio was playing audio through the Earphone Jack. See page 8.

## Specifications

---

### FREQUENCY COVERAGE:

FM Band: 87.5 - 108 MHz (Regular Mode).

FM Band: 76 - 108 MHz (Expanded Mode - See page 11).

AM Band: 520 - 1710 kHz.

### Weather Band:

Channel 1: 162.400 MHz

Channel 2: 162.425 MHz

Channel 3: 162.450 MHz

Channel 4: 162.475 MHz

Channel 5: 162.500 MHz

Channel 6: 162.525 MHz

Channel 7: 162.550 MHz

### POWER SOURCE:

Batteries: (2) "AA" Alkaline or Rechargeable (NiMH). Do not use Lithium batteries.

**Note:** Lithium batteries can register at 1.8 volts. Using Lithium batteries that register higher than 1.6 volts can cause damage to the radio.

### POWER CONSUMPTION:

30 -100 mA DC (depending on headphone or speaker usage).

### AUDIO:

Speaker: 1.25", 8 Ohm, 0.5 Watts.

3.5mm Stereo headphone jack.

### ANTENNA:

FM and Weather Band: Built-in antenna, External Wire Antenna, or Headphones /Earbuds.

AM Band: Built-in Ferrite Bar.

### DIMENSIONS:

2.5" W x 4.25" H x 0.9" D.

### WEIGHT:

Approximately 3.5 ounces without batteries.

**Note:** Specifications are subject to change without notice.





Model: CCPocket

FCC ID: ATE20122228

THIS DEVICE COMPLIES WITH PART 15 OF THE FCC RULES.  
OPERATION IS SUBJECT TO THE FOLLOWING TWO  
CONDITIONS.

- 1) THIS DEVICE MAY NOT CAUSE HARMFUL INTERFERENCE,  
AND
- 2) THIS DEVICE MUST ACCEPT ANY INTERFERENCE  
RECEIVED, INCLUDING INTERFERENCE THAT MAY CAUSE  
UNDESIRE OPERATION.

**Notice:** Any changes or modifications not expressly approved by  
the party responsible for compliance could void the user's authority  
to operate the equipment.

**Copyright ©2020 by C. Crane, Fortuna, CA 95540**

**Phone: 1-800-522-8863 Web: *ccrane.com***

All rights reserved. No part of this booklet may be reproduced, in  
any form or means whatsoever, without permission in writing from  
C. Crane.