

### ONE YEAR LIMITED WARRANTY

C. Crane Company, Inc. warrants this product to be free from defects in material and workmanship under normal use and conditions for a period of one year from the date of original purchase. This warranty covers parts and labor.

Should service be necessary for any reason due to manufacturing defect or malfunction during the warranty period, send it to C. Crane Company, Inc. Service Department, 558 10th St., Fortuna, CA 95540. Upon delivery of this item to our center with a copy of proof of purchase date, C. Crane Company, Inc. will repair or replace, at its discretion, the defective merchandise at no charge (except for your packing and shipping cost).

Should service be required:

- 1) Carefully pack the unit along with the AC Adapter in original packing cartons or a suitable well padded corrugated box.
- 2) Enclose a copy of proof of date of purchase and a note describing your specific problem or call 1-800-522-8863 and we will take care of the paperwork.
- 3) Ship the unit **insured** via UPS, Parcel Post or Priority Mail. Priority mail in most cases is the most timely and reasonable cost.

NOTE: This warranty does not cover:

- A) Units that have been misused, neglected, dropped or damaged by accident.
- B) Units that have been repaired or altered by persons other than C. Crane Company, Inc.

This warranty is valid only in the United States of America and Canada and does not extend to owners of the products subsequent to the original purchase. Any applicable implied warranties, including the warranty of merchantability, are limited in duration to a period of one year from the date of original purchase; no warranties, whether expressed or implied, shall apply to this product thereafter. Under no circumstances shall C. Crane Company, Inc. be liable for any loss or damage, direct or consequential arising out of the use of, or inability to use this product, (Some states do not allow limitation or implied warranties or exclusion of consequential damage, therefore, these restrictions may not apply to you). This warranty gives you specific legal rights and you may also have other rights which vary from state to state. The buyer has the right to bring in any action at law or equity to resolve disputes concerning or to enforce the provisions of this warranty.

**C. CRANE  
COMPANY**

C. Crane Company, Inc., Service Dept.  
1001 Main Street, Fortuna CA 95540  
1-800-522-8863

Model: ES Recorder / CCRRecorder Version 10.99

This device complies with Part 15 of the FCC rules. Operation is subject to the following two conditions: (1) This device may not cause harmful interference, and (2) this device must accept any interference received, including interference that may cause undesired operation. Class B device.

Revised 10/99

# CCRRecorder



by ES Quality Products



Digital Recorder With Voice Prompt

## Instruction Manual

**WARNING: TO PREVENT FIRE OR ELECTRIC SHOCK HAZ-  
ARD, DO NOT EXPOSE THIS PRODUCT TO RAIN OR MOISTURE.**

	<div><div><b>CAUTION</b></div><div><b>RISK OF ELECTRIC SHOCK DO NOT OPEN</b></div></div>	
THE LIGHTNING FLASH AND ARROWHEAD WITHIN THE TRIANGLE IS A WARNING SIGN ALERTING YOU OF "DANGEROUS VOLTAGE" INSIDE THE RECORDER.	CAUTION: TO REDUCE THE RISK OF ELECTRIC SHOCK, DO NOT REMOVE THE BACK. NO USER SERVICEABLE PARTS INSIDE. REFER SERVICING TO QUALIFIED SERVICE PERSONNEL.	THE EXCLAMATION POINT WITHIN THE TRIANGLE IS A WARNING SIGN ALERTING YOU OF IMPORTANT INSTRUCTIONS ACCOMPANYING THIS RECORDER.

Copyright © 1999 by C. Crane Company, Inc., Fortuna, CA 95540

All rights reserved. No part of this booklet may be reproduced, in any form or means whatsoever, without permission in writing from C. Crane Company, Inc. CCRecorder is subject to the Copyright Laws of the United States of America and any other country in which it is operated. The recorder is for use in accordance with the Digital Copyright Act of the United States of America. The CCRecorder is sold for personal and fair use of any copyrighted broadcast use and not for commercial use including but not limited to re-transmission of any copyrighted broadcast without the written consent of the copyright owner.

[illegible]

## TABLE OF CONTENTS

34

## SAFETY INSTRUCTIONS

**READ BEFORE OPERATING EQUIPMENT**  
**SAVE THESE INSTRUCTIONS**

1. Read and understand all safety and operating instructions before the recorder is operated.
2. Retain Instructions: The safety and operating instructions should be retained for future reference.
3. Heed Warnings. All warnings on the appliance and operating instructions should be followed.
4. Follow all operations and use instructions.
5. Water and Moisture: The appliance should not be used near water. Do not use near a bathtub, washbowl, laundry tub, kitchen sink, wet basement, swimming pool, etc.
6. Unplug the recorder from the AC power outlet before cleaning. Use only a damp cloth for cleaning the exterior of the recorder.
7. Do not place the recorder on an unstable cart, stand, bracket or table. The recorder may fall, causing serious personal injury and/or damage to the recorder.
8. Ventilation: This recorder should be situated so that its location or position does not interfere with its proper ventilation. For example, the recorder should not be used on a bed, sofa, rug or other soft surfaces that may block the ventilation openings. It should not be placed in a built-in situation like a cabinet that may reduce air flow through the ventilation openings.
9. Heat: Never put the recorder in direct sunlight, in an unventilated area, or behind glass (like a car's interior). The appliance should be away from any heat sources such as radiators, heat registers, stoves, or other appliances that produce heat.
10. Power Supply: The power supply should be positioned so it is not walked on, pinched, or items placed on top of it. Pay particular attention to cords at plugs, convenience receptacles, and the point where they exit from the unit. Unplug the power supply by gripping the power plug, not

## CUSTOM SETUP TIME RECORDING LOG

[illegible]

## SPECIFICATIONS

---

### POWER SOURCE

16V AC, 1.1 A Transformer

### AUDIO

Speaker: 3-1/2", 1 Watt Total

### DIMENSIONS

4" H x 4-1/2" W x 9" D

### WEIGHT

3 lbs.

Note: Specifications are subject to change without notice.

## CAUTION

---

The CCRecorder contains a Hard Drive. **DO NOT DROP!** Damage is likely if dropped.

KEEP ALL SCREWS SNUG. Do not unscrew, metal washers and nuts will become loose inside the CCRecorder case. This is especially true for the 2 screws in back, and the 4 screws which hold the hard disk to the bottom base. Any loose washers or nuts inside the case can short-circuit the electronics.

To reduce the risk of electric shock, do not remove the bottom cover. No user serviceable parts are inside. Refer servicing to qualified service personnel.

If listening to a weak station, position the CCRecorder and other computer equipment several feet from radio.

the cord. Operate the recorder using only the correct type of power source indicated. If you are not sure of the type of power supply to your home, consult your dealer or local power company.

11. Do not overload wall outlets or extension cords. This can result in a risk of fire or electrical shock. Never insert objects of any kind into the recorder through openings. The objects may touch dangerous voltage points or short out parts. This could cause a fire or electrical shock.

12. If the recorder is left unattended and unused for long periods of time, unplug it from the wall outlet. This will prevent damage caused by lightning or power line surges.

13. Do not attempt to service the recorder yourself. Removing the cover may expose you to dangerous voltage, and will void the warranty. Refer all servicing to authorized service personnel.

14. The appliance should be serviced by qualified service personnel when:

- A. The power supply or jacks have been damaged or
- B. Objects have fallen or liquid has been spilled into the recorder or
- C. The recorder has been exposed to rain or
- D. The recorder does not appear to operate normally or exhibits a marked change in performance or
- E. The recorder has been dropped, or the enclosure damaged.

15. The user should not attempt to service the appliance beyond that described in the operating instructions. All other servicing should be referred to qualified service personnel.



This symbol is to alert you to important operation or servicing instructions that may appear in the owner's manual.

## INTRODUCTION

---

The CCR recorder is an incredible new digital hard drive device designed primarily for talkshow recording. Simple record and playback are accomplished by pressing only a few buttons. It is also equipped with Quick Setup letter codes that can be used to program a complete weekly schedule for many popular talkshows. You can completely customize recording times for special uses to the split second. Also built into the CCR recorder is a continuous playback feature. Left unattended, it will chain all of your recordings sequentially to playback forever. Great for background music and numerous other applications.

The voice prompt version, speaks the time and confirms the quick codes that are set.

Development of the CCR recorder began in 1993 by Edmund Strauss, inventor and engineer for this unique recording device. It comes with a one year warranty serviced by C. Crane Company, Inc.

**For those of you who would like to Quick Start, go directly to page 7.** Please read the complete manual for all the features the CCR recorder offers.

## UNPACKING

---

The CCR recorder contains a Hard Drive. **DO NOT DROP!** Damage is likely if dropped. The box should contain the CCR recorder, the power supply, one 6' patchcord, and this manual. If anything is missing or damaged please contact your dealer immediately. We recommend you keep the box in the unlikely event your CCR recorder will need servicing.

## FEATURES

---

- 115 hrs of record time in monaural
- 15 hrs in cassette quality full stereo
- Built-in microphone plus two programmable inputs
- With the built in speaker you can monitor live recordings.
- Headphone jack for listening or output to another recording device
- Quick Setup feature allows you to record many popular shows in a few seconds.
- You can set it up to automatically play back at a different time.
- << and >> keys allow you to scan back or forward.
- Mono, 2:1 compression at 8-bit with 10.4 KHz sample rate
- Voice prompt and quick code confirmation
- Stereo, no compression at 16-bit with 20 KHz sample rate on each channel
- Mute/Pause can stop playback or mute the recording session.
- Pre-program to record up to 16 events of any length at any time of the week.
- Will store up to 240 separate recordings.
- 10 yr. lithium battery backup to retain time
- Timestamp is displayed during playback
- 90 minute sleep timer.
- Capable of playback in reverse
- Continuous record mode from mic or input for security or monitoring

## RECORDING TIPS

---

- \* Make sure your audio source is receiving your desired station clearly.
- \* Make sure the hookup is correct from the headphone jack of the radio/receiver to the CCR recorder.
- \* Check recording times you have chosen against station broadcast times.
- \* Make sure you prepare the CCR recorder to record automatically by pressing **RECORD** button until the red light stays on after setting any **QUICK SETUP** or **Custom SETUP** Record times.
- \* If recording a late night shows, press the **MUTE** button on the CCR recorder, (after checking volume level), for silent recording.
- \* What if the **RECORD** button was not pressed for automatic (timed) record and your start time has passed? Press, the **RECORD** button and the session button it was set to record in. The recorder will stop at your set **END** time automatically.
- \* Make sure when setting **Custom SETUP** times to choose **DAYS TO RECORD** with each time entered. (including Start, Break, Resume End and Playback times).
- \* When AUTO PLAYBACK has been set, make sure that **ALARM ON** has been set by pressing session **A** button while recorder is idle until **AL ON** is displayed.
- \* At any time, push the display button to hear an audible explanation of the display and record status.
- \* For further tips and feedback, go to [www.ccrecorder.com](http://www.ccrecorder.com) on the internet.

## TROUBLE SHOOTING

If necessary to do a super-reset of the CCRecorder, to clear any strange condition(s), press-and-hold both the **A** and **C** buttons (All Clear) simultaneously during power-on, until the time is shown on the display. The CCRecorder should return to an idle condition, ready to use again. All recordings and setup times are still preserved on the hard disk.

### Be Careful, Do you really want to do this?

If necessary to erase ALL the recordings on entire disk, and ALL the **SETUP** Times, press-and-hold the 4 session buttons **E**, **F**, **G**, and **IMMED.** simultaneously during power-on until the time is shown on the display. This restores the Recorder to a "factory-new" condition. Note: All the green lights momentarily illuminate for 1 second as confirmation that the hard disk directory is being re-initialized.

## BUTTON IDENTIFICATION

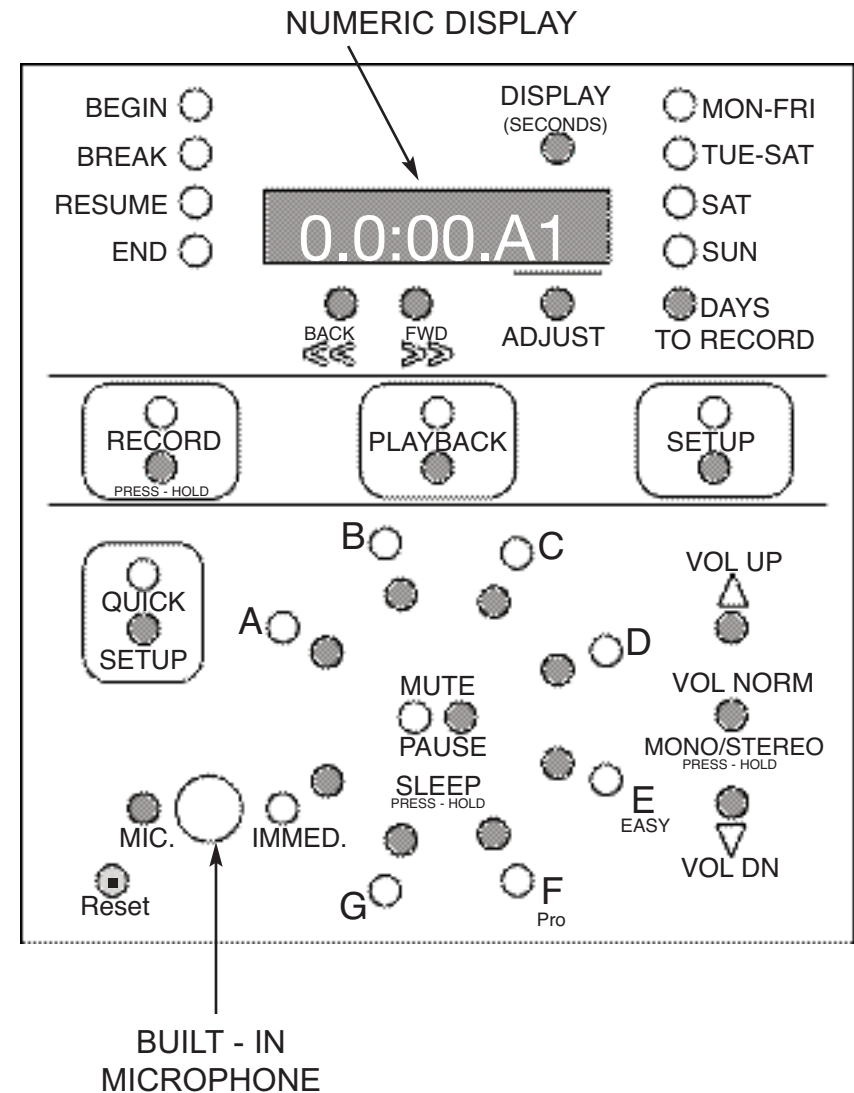



## GETTING STARTED

### POWERING YOUR CCRECORDER

Before powering your CCREcorder be sure to read the **Safety Instructions on page 1**. The CCREcorder will run on the supplied 16V AC adapter when powered by 120V AC house current. Before you plug the power supply into the CCREcorder, be sure the AC voltage is 120Volts/60Hz.

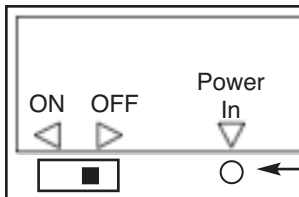

On the back of the recorder, insert the plug on the end of the supplied power supply into the AC **POWER IN** jack.

Switch the CCREcorder's rear power **ON/OFF** switch to the '**ON**' position. The CCREcorder will spin-up its hard disk and then will display the time on its red numeric display. If the displayed time is not correct, see next page for directions.

### DISPLAY PANEL

#### Display Panel in Idle mode

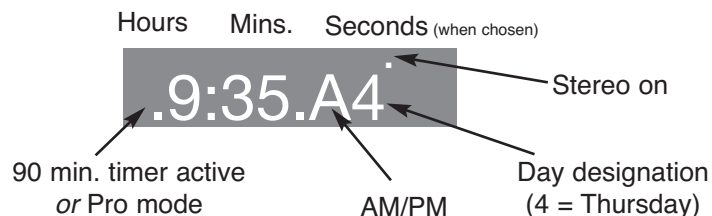

#### Display Panel in Playback mode



## SETTING MODES

To set the **EASY** mode, just press the **E** button when the CCREcorder is idle. The display will read "**EASY**" for several seconds. The **EASY** mode is the normal mode of operating. The CCREcorder can be in either mode to set **QUICK SETUP** codes.

To set the "**PRO**" mode, press-and-hold session **F** button for about 4 seconds when the CCREcorder is idle. The display will read "**.Pro**" for several seconds, and the small red "decimal-point" light in lower left area of the display will remain on while you remain in the **Pro** mode.

Both the **QUICK SETUP** and **CUSTOM SETUP** times programmed to record or playback work while in either **EASY** or **PRO** modes.

## MUTE/PAUSE

To pause the playback, press the **MUTE/PAUSE** button.

The mute button can be used while recording if you wish to listen to your recording at a later time.

## AUTO RESTORE

After a power failure, and the eventual return of power, the Recorder will restore itself to whatever it was doing at one second before the power failure. It will return to **RECORD** mode, or **PLAYBACK** mode, if it was in either of those modes immediately prior to the power failure.

## RESET BUTTON

The CCREcorder contains a circuit to reliably reset itself whenever the power is switched on. The **RESET** button performs the same function, as removing and re-applying the power without actually turning it off. The **RESET** button just resets the CCREcorder's computer to the beginning state. It does not erase the audio programs or programming from the hard disk.





## ERASE UNWANTED RECORDINGS

To erase the event that is playing back, press-and-hold the **VOL NORM** button for about 3 seconds during playback, until the display shows **ERASED**. The recording is replaced with approx. 2 seconds of silence.

### Be Careful, Do you really want to do this?

To Erase ALL recordings **QUICK SETUP** and **CUSTOM SETUP** times, switch off the CCR recorder, then switch the CCR recorder on while quickly pressing and holding the **C, D, E, F** buttons (hold down all four keys). Continuing to hold all four session buttons simultaneously down while the CCR recorder is initializing, until the CCR recorder displays the present time as normal.

## PLAYBACK IN REVERSE

"Double-Clicking" the **MUTE/PAUSE** button during playback of any recording will cause the playback to go IN REVERSE. Time Stamp display will also count backwards when playing in reverse. Playback will also chain events in reverse.

While playback in reverse is being performed press the **VOL NORM** to change the reversal playback speed between normal 100% reverse speed, and a slowed-down 75% reverse speed.

To resume forward-direction playback, double click the **MUTE/PAUSE** button again. If necessary to restore 100% speed, press **VOL NORM** again.

## SELECT AUDIO SOURCE (PRO STATE)

When the CCR recorder is in **Pro** state and idle, press the **DISPLAY** button several times until the display shows "**src rA**" (Radio Line In), use the **ADJUST** button to select "**src AU**" (Aux Line In), or "**src PH**" (Built-In Microphone). While the CCR recorder is idle, before going to custom setup you can switch to any of these sources to **record** from. To set an audio source other than Radio Line In, for your programmed recording event press **DISPLAY** button while in setup and change to your desired input source.

To avoid microphone squeal while in "**src PH**" mode use headphones in the **External Speaker Out** jack or press the **MUTE** button.

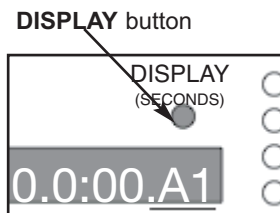

## SETTING THE CLOCK

If necessary to correct the time, have the CCR recorder idle, and press the **BACK<<** or **FWD >>** buttons to correct the present time display. Then press the **ADJUST** button to set the AM/PM and the "number" of the day-of-week. The day-of-week is designated as 1 for Monday, 2 for Tuesday, etc. Example: 10:45PM on Friday = 10:45.P5 on the CCR recorder display. Example: 8:37AM on Sunday = 8:37.A7 on the Recorder display.

To see the seconds, press the **DISPLAY (Seconds)** button. And, if you know the exact moment when seconds = 00, then press the **ADJUST** button at that exact moment, to snap the seconds display to **00**. Then if the minutes are incorrect, use the **BACK<<** or **FWD >>** buttons again to correct the minutes without disturbing the incrementing of the seconds.

To lock the clock display so the time cannot be changed: with the recorder idle, press and hold the **G** button for about 3 seconds until the display reads "**Loc On**". The clock time cannot be changed until the lock feature is turned off. Turn the lock off by pressing and holding the **G** button again, with the recorder idle, until display reads "**Lock Off**".

## VOICE PROMPT FEATURE

Press the **DISPLAY** button while recorder is idle to hear the time, day and mode status. Pressing the **DISPLAY** button again, will stop the speech.

While in the playback mode press the **DISPLAY** button to hear the session, level and time stamp. If the **DISPLAY** button is pressed while in setup mode, you will hear session, the time on the display, days to record and recording source.

When setting the quick setup codes, the recorder confirms the number on the display.

To hear an ongoing count of the live seconds, press and hold down the **DISPLAY** button. The Recorder will say "seconds: eighteen, nineteen, twenty-one, etc." until you release the **DISPLAY** button.

## 90 MINUTE SLEEP TIMER

To activate the 90-minute sleep timer, press-and-hold the **MUTE/PAUSE** button until the "**SLP 90**" message appears momentarily on the display. The small light along the bottom left of the numeric display stays on to indicate the 90-minute sleep timer is active. In 90 minutes, the

CCRecorder will automatically go to a mute condition, and any playback will stop. Pressing the **MUTE/PAUSE** button again cancels the 90 minute sleep timer. Recording is completely unaffected by the sleep timer.

## STEREO RECORDING

Your CCRewriter is factory set to record talk radio. If you want to record in stereo you must press the **VOL NORM** button for one second prior to recording. You will see a small stereo indicator light (in the upper right side of the numeric display region). When recording voice talk radio, mono setting should be used. Stereo setting will greatly reduce available recording space on the hard drive.

## RECORDING WITH BUILT-IN MIC

To record from the built-in microphone, press-and-hold the **RECORD** button, then press the **MIC** button. Be sure to record more than 2 seconds because if you wish to erase you must hold down the **VOL NORM** button for 2 seconds while the event is playing.

To stop the recording, press-and-hold the **RECORD** button again.

To playback your recording, simply push **PLAYBACK** button. When you press **PLAYBACK** the CCRewriter will find the most recent recording and play it back. When finished it will continue to search for events in **IMMED.** until the next one is found. To stop **PLAYBACK**, press **PLAYBACK** again.

## RECORDING FROM AN EXTERNAL AUDIO SOURCE

Plug the supplied patch cord into the headphone-out jack of a radio, (or other device). Plug the other end into the CCRewriter's jack labeled '**RADIO LINE IN**'. You can then hear the radio playing through the CCRewriter's built-in speaker. Position the radio about four feet away from the CCRewriter (and computers, etc.) to reduce radio noise.

Adjust the radio's volume to be moderately loud. Thereafter, you can adjust the listening volume using the CCRewriter's control panel buttons marked **VOL UP**, **VOL NORM**, **VOL DN**. The **MUTE** button can be used if you desire complete silence.

Press and hold the **RECORD** button until the red record light comes on. Then, to begin a recording, press any of the 8 Sessions: **A**, **B**, **C**, **D**, **E**, **F**, **G**, or **IMMED**. The red **RECORD** light will flash when the recording is being made. The **MUTE** button does not effect recording.

Two events can be programmed for each session button, by using the **Break** and **Resume** functions as **Start**, and **End** times. Up to 16 events can be recorded using this method (2 events in each of the 8 sessions). There is no time limit for each event.

You will hear the hard disk spin-up momentarily when you leave the **SETUP** mode as the new setup is saved to disk.

## AUTO PLAYBACK/ALARM

While in **PRO** mode press the **SETUP** key, then press one of the session buttons repeatedly. To set Auto Playback ON time, (indicated by all four red lights on, See figure). Adjust the display to read the time you desire automatic playback to begin using the **FWD >>** and **BACK <<** keys, make sure

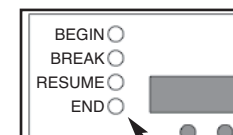

ALL FOUR lights ON/OFF

to set AM or PM and **DAYS TO**

**RECORD** (which is also Days to Auto

Playback). Auto Playback will begin with your most recent recorded event, and will chain to playback all events, depending upon how long the Auto Playback is allowed to continue. The Auto Playback time must be the same number of minutes as the record time or the unit will cycle until an **END** time is found. Add your exact record time to determine your exact playback time.

While displaying the Auto Playback OFF Time, (indicated by all 4 red lights off), adjust the display to read the time you desire Auto Playback to end using the **FWD >>** and **BACK <<** keys, make sure to set AM or PM and **DAYS TO RECORD** (which is also Days to Auto Playback). To set the Auto playback ON or Alarm ON, to playback at your programmed time, with the CCRewriter idle, press-and-hold session **A** button. The display must read "**AL ON**", for the Auto Playback to be active. To disable the Auto Playback or Alarm Off, press-and-hold session **A** button with the CCRewriter idle until "**AL Off**" is displayed. You cannot record and playback at the same time. Your most recent action takes precedence over any timed recording or playback programmed into the unit.

Press **C**, **RESUME** light is on, Press **FWD >>** until display reads **11:35**.  
Press **ADJUST** button, set **A** (for AM).  
Press **DAYS TO RECORD** to select **MON-FRI**.  
Press **C**, **END** light is on, Press **FWD >>** until display reads **12:00**.  
Press **ADJUST** button, set **P** (for PM).  
Press **DAYS TO RECORD** to select **MON-FRI**.

While in Setup mode you can delete a record time by holding the **DAYS TO RECORD** button, until display reads **0:00A**.

### ***Set Automatic Playback Time***

Press **A**, until all lights **BEGIN** through **END** are on, Press **FWD >>** until display reads **6:00** to set Start Playback time.  
Press **ADJUST** button, set **P** (for PM).  
Press **DAYS TO RECORD** to select **MON-FRI**.  
Press **A**, all lights **BEGIN** through **END** are off, Press **FWD >>** until display reads **8:30** to set End Playback time.  
Press **ADJUST** button, set **P** (for PM).  
Press **DAYS TO RECORD** to select **MON-FRI**.  
Press **SETUP** button, until yellow light is off. Display will show **A1**.

Note: Playback can be set under any session button. The playback duration must be the same number of minutes as the record time or the unit will cycle until an “**END**” time is found. Add your exact record time programmed into each session to determine playback needed. In our example it is 150 mins. or 2-1/2 hours.

### ***Set Auto playback to come on***

With the CCRecorder idle, press-and-hold session **A** button until display reads **AL ON**.

The CCRecorder is now set to playback at our designated times.

CCRecorder is idle. To initialize your CCRecorder press the **RECORD** button until the red light stays on. Your CCRecorder will now record automatically from 9:05 AM to 12:00 PM and record into sessions A, B, and C. Be sure your radio is on and plugged into the CCRecorder.

Note: We put each hour into a separate session to cut out the commercials. The CCRecorder will automatically chain the events on playback. You can also select which hour of the show you would like to listen to manually with this method by selecting each session button during playback.

Recording will continue until you press-and-hold the **RECORD** button again, until the disk is full or a programmed "end time" has been reached. Be sure to record more than 2 seconds because if you wish to erase you must hold down the **VOL NORM** button for 2 seconds while the event is playing.

In each of the separate Sessions, labeled **A, B, C, D, E, F, G**, and **IMMED**, the CCRecorder stores up to 15 events. All events in the sessions are accessible at any time during playback, by pressing the **A, B, C, D, E, F, G**, or **IMMED**. buttons multiple times during playback, to access older recordings (or events).

## **PLAYBACK**

---

When you press **PLAYBACK** the CCRecorder will attempt to find the most recent event in Session **A**. If nothing is recorded it will continue to search sessions **B** through **G** until an event is found. To stop **PLAYBACK**, press **PLAYBACK** again.

To loop an individual recording to playback continuously--On the recording you wish to loop, quickly press the **PLAYBACK** button 2 times while playback is being performed. The display will read “**Loop**”. When the recording is finished, it will start at the beginning of the individual recording and repeat until you push the **PLAYBACK** button again 2 times and the display reads “**Unloop**”.

To hear older events in a Session, press **A, B, C, D, E, F, G** or **IMMED**. buttons multiple times in rapid succession. The most recent recorded event plays first. The 15 event levels are numbered as 1, 2, 3, 4, 5, 6, 7, 8, 9, A, b, C, d, E, F. During playback, the number of the event is shown at the far right side of the numeric display.

To fast scan the event use the **BACK <<** or **FWD >>** buttons to advance in 60 second increments. To scan in slower 10 second increments use the dual purpose keys **<<ADJUST** button and the **DAYS TO RECORD>>** button. If you scan beyond the current event, playback will chain quickly to the next session.

## RECORDING WITH QUICK SETUP CODES

Refer to the following code listings for recording specific times of radio programs. Codes for your **favorite talkshow host** are shown on the next page. Should your radio program not be mentioned by name there, please refer to the extensive code lists, for the time of the radio show you wish to record or use a **Custom Setup** time explained on page 24 of this manual.

**How to enter a Quick Setup Code:** Press session **E** Button for **Easy mode** before beginning. Enter **Quick Setup Codes** from this mode.

Press the "**QUICK SETUP**" button to begin. Notice the yellow light by the **QUICK SETUP** button has turned on. Wait until the numeric display shows a single digit of zero: "0"

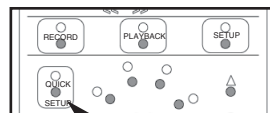

QUICK SETUP Button

From the following code lists, select the Quick Setup Code that is appropriate for the days-of week and the time of the radio program you wish to record. The codes consist of several of the lettered keys **A, B, C, D, E, F, G**, and **IMMED**. Enter the code letters by pressing the corresponding keys, one key at a time.

The display will show a Confirming Number, which needs to match the **Conf. #** from your **Quick Setup code**. If the Confirming Number is not correct, press the recorder's **MUTE** button to clear the code and clear the display to zero (0), then re-enter the code letters one button at a time, and check the Confirming Number. When the Confirming Number is correct, proceed to the next step.

Press the **QUICK SETUP** button again to complete. The yellow light by the **QUICK SETUP** button will turn off, the hard disk inside the CCR recorder will "spin-up" briefly to save the new Quick Setup Code, and the display will show a confirming message, "**Code Has Been Set.**" That completes the actual Quick Setup.

Now your CCR recorder is "idle" again, merely displaying the current time. Finally, press-and-hold **RECORD** button until light stays on to set your CCR recorder for automatic recording. Be sure your radio is on, set to the station you will be recording from, and plugged into the CCR recorder.

To clear ALL of your previous **Quick Setup Codes** and **Custom Time Record Setup**, while in **Quick Setup Mode**, press session buttons **C**, and **A**, your confirming number is 5.

With the CCR recorder idle, press-and-hold, session **F** button until display reads **".Pro"**.

Press **SETUP** button until yellow light stays on.

Press session **A** button (or any button **A** thru **G** or **IMMED.**).

Press **DAYS TO RECORD** and select **MON-FRI**.

**BEGIN** light is on, Press **FWD >>** to run clock to display **9:05**.

Press **ADJUST** button, set **A** (for AM).

Press **A**, **BREAK** light is on, Press **FWD >>** until display reads **9:30**.

Press **ADJUST** button, set **A** (for AM).

Press **DAYS TO RECORD** to select **MON-FRI**.

Press **A**, **RESUME** light is on, Press **FWD >>** until display reads **9:35**.

Press **ADJUST** button, set **A** (for AM).

Press **DAYS TO RECORD** to select **MON-FRI**.

Press **A**, **END** light is on, Press **FWD >>** until display reads **10:00**.

Press **ADJUST** button, set **A** (for AM).

Press **DAYS TO RECORD** to select **MON-FRI**.

Press session **B** button.

Press **DAYS TO RECORD** and select **MON-FRI**.

**BEGIN** light is on, Press **FWD >>** until display reads **10:05**.

Press **ADJUST** button, set **A** (for AM).

Press **B**, **BREAK** light is on, Press **FWD >>** until display reads **10:30**.

Press **ADJUST** button, set **A** (for AM).

Press **DAYS TO RECORD** to select **MON-FRI**.

Press **B**, **RESUME** light is on, Press **FWD >>** until display reads **10:35**.

Press **ADJUST** button, set **A** (for AM).

Press **DAYS TO RECORD** to select **MON-FRI**.

Press **B**, **END** light is on, Press **FWD >>** until display reads **11:00**.

Press **ADJUST** button, set **A** (for AM).

Press **DAYS TO RECORD** to select **MON-FRI**.

Press session **C** button.

Press **DAYS TO RECORD** and select **MON-FRI**.

**BEGIN** light is on, Press **FWD >>** until display reads **11:05**.

Press **ADJUST** button, set **A** (for AM).

Press **C**, **BREAK** light is on, Press **FWD >>** until display reads **11:30**.

Press **ADJUST** button, set **A** (for AM).

Press **DAYS TO RECORD** to select **MON-FRI**.



## CUSTOM RECORD TIME SETUP

The **Professional** mode allows you to customize record times. To enter **Professional** mode, have the Recorder idle, then press-and-hold the "**F Pro**" button for about 3 seconds until the display shows "**.Pro**". The small light along the bottom left of the numeric display stays on to indicate **Pro** mode. (This is the same light for 90 min. sleep timer, 90 min. sleep timer will activate if set in either **Pro** or **EASY** mode).

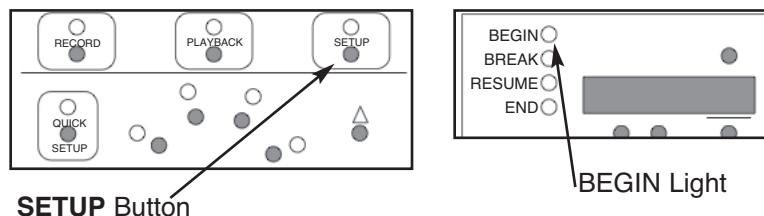

### Custom Record Time Setup

Example: Set to record a show Mon-Fri from 2:00 PM to 3:00 PM.

With the CCR recorder idle, Press and hold session **F** button until display reads "**.Pro**".

Press **SETUP**, (above), button until yellow light stays on.

Press session **A** button (or any button **A** thru **G** or **IMMED**).

Press **DAYS TO RECORD** button, and select **MON-FRI**.

Set **BEGIN** time by using **FWD >>** and **BACK <<** buttons until display reads **2:00**.

Press **ADJUST** button, set **P** (for PM).

Press session **A** button several times until **END** light is on.

Press **DAYS TO RECORD** button, and select **MON-FRI**.

Set End time by using **FWD>>** and **BACK<<** until display reads **3:00**.

Press **ADJUST** button, set **P** (for PM) .

Press **SETUP** button until yellow light goes out. Display will show **A1**.

To initialize your CCR recorder press the **RECORD** button until the red light stays on. Your CCR recorder will now turn on automatically from **2:00 to 3:00 PM** and record into session **A**. Be sure your radio is on and plugged into the CCR recorder.

### Advanced Custom Record Time Setup

Example: Set to record from 9:05 AM to 12:00 PM (noon) Mon-Fri, and eliminate most commercials. Also we will playback the program automatically at 6:00 PM daily when I get home. (Early day!)

Use this page to find your **favorite talkshow host** and the times they come on in your area.

Reference for setup:

Press **QUICK SETUP** button, Enter **Quick Code**, Check **Confirming #**, Press **QUICK SETUP** button, Press **RECORD** until light stays on.

HOST/SHOW	START TIME/DAY	QUICK CODE	CONF. #	EVENT LOCATION
Art Bell/Coast to Coast	7:05pm/M-F	D,E	24	A
Art Bell/Coast to Coast	8:05 pm/M-F	A	1	A
Art Bell/Coast to Coast	9:05 pm/M-F	B	2	A
Art Bell/Coast to Coast	10:05 pm/M-F	A,B	3	A
Art Bell/Coast to Coast	11:05 pm/M-F	C	4	A
Art Bell/Coast to Coast	12:05 am/M-F	B,C	6	A
Art Bell/Coast to Coast	1:05 am/M-F	A,B,C	7	A
Art Bell/Dreamland	5:05 pm/Sun	A,D,IMMED	137	F
Art Bell/Dreamland	6:05 pm/Sun	B,D,IMMED	138	F
Art Bell/Dreamland	7:05 pm/Sun	A,B,D,IMMED	139	F
Art Bell/Dreamland	8:05 pm/Sun	C,D,IMMED	140	F
Art Bell/Dreamland	9:05 pm/Sun	A,C,D,IMMED	141	F
Art Bell/Dreamland	10:05 pm/Sun	B,C,D,IMMED	142	F
Art Bell/Dreamland	11:05 pm/Sun	A,B,C,D,IMMED	143	F
Bob Brinker/MoneyTalk	10:05 am/S-S	B,E,G	82	D
Bob Brinker/MoneyTalk	11:05 am/S-S	A,B,E,G	83	D
Bob Brinker/MoneyTalk	12:05 am/S-S	C,E,G	84	D
Bob Brinker/MoneyTalk	1:05 pm/S-S	A,E,G	85	D
Bob Brinker/MoneyTalk	2:05 pm/S-S	B,C,E,G	86	D
Bob Brinker/MoneyTalk	3:05 pm/S-S	A,B,C,E,G	87	D
Bob Brinker/MoneyTalk	4:05 pm/S-S	D,E,G	88	D
Rush Limbaugh	8:05 am/M-F	F	32	B
Rush Limbaugh	9:05 am/M-F	A,F	33	B
Rush Limbaugh	10:05 am/M-F	B,F	34	B
Rush Limbaugh	11:05 am/M-F	A,B,F	35	B
Rush Limbaugh	12:05 pm/M-F	C,F	36	B
Rush Limbaugh	1:05 pm/M-F	A,C,F	37	B
Rush Limbaugh	2:05 pm/M-F	B,C,F	38	B

Sun = Sunday only

S-S = Saturday and Sunday

M-F = Monday through Friday

If the confirming number is incorrect, simply press the recorder's **MUTE** button to clear the code to zero, then re-enter the correct code. For further information on clearing codes see page 23.

Use this page to find a **5 hour** time slot, **Monday through Friday** you wish to record and enter the **Quick setup code** of your choice.

Reference for setup:

Press **QUICK SETUP** button, Enter **Quick Code**, Check **Confirming #**,

Press **QUICK SETUP** button, Press **RECORD** until light stays on.

START TIME	LENGTH/DAYS	QUICK CODE	CONF. #	EVENT LOCATION
1:05am	5hrs/M-F	A,B,C	7	A
2:05am	5hrs/M-F	D	8	A
3:05am	5hrs/M-F	A,C,E,F,IMMED	181	A
4:05am	5hrs/M-F	A,D	9	A
5:05am	5hrs/M-F	B,D	10	A
6:05am	5hrs/M-F	A,B,D	11	A
7:05am	5hrs/M-F	C,D	12	A
8:05am	5hrs/M-F	A,C,D	13	A
9:05am	5hrs/M-F	B,C,D	14	A
10:05am	5hrs/M-F	A,B,C,D	15	A
11:05am	5hrs/M-F	E	16	A
12:05pm noon	5hrs/M-F	A,E	17	A
1:05pm	5hrs/M-F	B,E	18	A
2:05pm	5hrs/M-F	A,B,E	19	A
3:05pm	5hrs/M-F	C,E	20	A
4:05pm	5hrs/M-F	A,C,E	21	A
5:05pm	5hrs/M-F	B,C,E	22	A
6:05pm	5hrs/M-F	A,B,C,E	23	A
7:05pm	5hrs/M-F	D,E	24	A
8:05pm	5hrs/M-F	A	1	A
9:05pm	5hrs/M-F	B	2	A
10:05pm	5hrs/M-F	A,B	3	A
11:05pm	5hrs/M-F	C	4	A
12:05am midnight	5hrs/M-F	B,C	6	A

M-F = Monday through Friday

If the confirming number is incorrect, simply press the recorder's **MUTE** button to clear the code to zero, then re-enter the correct code. For further information on clearing codes see page 23.

The following quick setup codes are for recording **24 hours a day Seven Days a Week**. By using these codes the CCRecorder will start recording at the first hour divisible by 3, as in 3:00, 6:00, 9:00 or 12:00. Six hours of recording time goes into each session **A, B, C**, and **D**. There is a few second break every 3 hours. The recorder will contain 115 hours of the most current data, as old data is automatically deleted.

Source: Radio Line In

Code: B,C,E,G,IMMED. Confirming # 214

Source: Built In Microphone

Code: A,B,C,E,G,IMMED. Confirming # 215

To delete the 24 hour automatic record times you must use clearing codes for each of the 4 letter session codes.

To clear a specific quick set up code, press **QUICK SETUP** up button, enter the code to be cleared, press **VOL NORM** button until a minus sign is shown on the left of the display. Press **QUICK SETUP** button again. Recorder will tell you which quick set code was cleared.

The **C,A** Code clears ALL Quick Setup and Custom Setup record times. No recordings on the disk are erased by using any of these clearing codes.

TO CLEAR ALL SESSION	QUICK CODE	CONF#
ALL	C,A	5

If the confirming number is incorrect, simply press the recorder's **MUTE** button to clear the code to zero, then re-enter the correct code.



The following are all **3 hour** shows.

HOST/SHOW	START TIME/DAY	QUICK CODE	CONF. #	EVENT LOCATION
Art Bell/Dreamland	5:05 pm/Sun	A,C,D,E,F,IMMED	189	F,G,IMMED
Art Bell/Dreamland	6:05 pm/Sun	B,C,D,E,F,IMMED	190	F,G,IMMED
Art Bell/Dreamland	7:05 pm/Sun	A,B,C,D,E,F,IMMED	191	F,G,IMMED
Art Bell/Dreamland	8:05 pm/Sun	G,IMMED	192	F,G,IMMED
Art Bell/Dreamland	9:05 pm/Sun	A,G,IMMED	193	F,G,IMMED
Art Bell/Dreamland	10:05 pm/Sun	B,G,IMMED	194	F,G,IMMED
Art Bell/Dreamland	11:05 pm/Sun	A,B,G,IMMED	195	F,G,IMMED
Bob Brinker/MoneyTalk	10:05 am/S-S	C,G,IMMED	196	F,G,IMMED
Bob Brinker/MoneyTalk	11:05 am/S-S	A,C,G,IMMED	197	F,G,IMMED
Bob Brinker/MoneyTalk	12:05 am/S-S	B,C,G,IMMED	198	F,G,IMMED
Bob Brinker/MoneyTalk	1:05 pm/S-S	A,B,C,G,IMMED	199	F,G,IMMED
Bob Brinker/MoneyTalk	2:05 pm/S-S	D,G,IMMED	200	F,G,IMMED
Bob Brinker/MoneyTalk	3:05 pm/S-S	A,D,G,IMMED	201	F,G,IMMED
Bob Brinker/MoneyTalk	4:05 pm/S-S	B,D,G,IMMED	202	F,G,IMMED
Bob Brinker/MoneyTalk	5:05 pm/S-S	A,B,D,G,IMMED	203	F,G,IMMED
Rush Limbaugh	8:05 am/M-F	C,D,G,IMMED	204	F,G,IMMED
Rush Limbaugh	9:05 am/M-F	A,C,D,G,IMMED	205	F,G,IMMED
Rush Limbaugh	10:05 am/M-F	B,C,D,G,IMMED	206	F,G,IMMED
Rush Limbaugh	11:05 am/M-F	A,B,C,D,G,IMMED	207	F,G,IMMED
Rush Limbaugh	12:05 pm/M-F	E,G,IMMED	208	F,G,IMMED
Rush Limbaugh	1:05 pm/M-F	A,E,G,IMMED	209	F,G,IMMED
Rush Limbaugh	2:05 pm/M-F	B,E,G,IMMED	210	F,G,IMMED
Rush Limbaugh	3:05 pm/M-F	A,B,E,G,IMMED	211	F,G,IMMED
Rush Limbaugh	4:05 pm/M-F	C,E,G,IMMED	212	F,G,IMMED
Rush Limbaugh	5:05 pm/M-F	A,C,E,G,IMMED	213	F,G,IMMED

M-F = Monday through Friday

S-S = Saturday and Sunday

Sun = Sunday only

All = Monday through Friday, Saturday and Sunday

If the confirming number is incorrect, simply press the recorder's **MUTE** button to clear the code to zero, then re-enter the correct code. For further information on clearing codes see page 23.

Use this page to find a **3 hour** time slot, **Monday through Friday** you wish to record and enter the **Quick setup code** of your choice.

Reference for setup:

Press **QUICK SETUP** button, Enter **Quick Code**, Check **Confirming #**, Press **QUICK SETUP** button, Press **RECORD** until light stays on.

START TIME	LENGTH/DAYS	QUICK CODE	CONF. #	EVENT LOCATION
1:05am	3hrs/M-F	A,D,E	25	B
2:05am	3hrs/M-F	B,D,E	26	B
3:05am	3hrs/M-F	A,B,D,E	27	B
4:05am	3hrs/M-F	C,D,E	28	B
5:05am	3hrs/M-F	A,C,D,E	29	B
6:05am	3hrs/M-F	B,C,D,E	30	B
7:05am	3hrs/M-F	A,B,C,D,E	31	B
8:05am	3hrs/M-F	F	32	B
9:05am	3hrs/M-F	A,F	33	B
10:05am	3hrs/M-F	B,F	34	B
11:05am	3hrs/M-F	A,B,F	35	B
12:05pm noon	3hrs/M-F	C,F	36	B
1:05pm	3hrs/M-F	A,C,F	37	B
2:05pm	3hrs/M-F	B,C,F	38	B
3:05pm	3hrs/M-F	A,B,C,F	39	B
4:05pm	3hrs/M-F	D,F	40	B
5:05pm	3hrs/M-F	A,D,F	41	B
6:05pm	3hrs/M-F	B,D,F	42	B
7:05pm	3hrs/M-F	A,B,D,F	43	B
8:05pm	3hrs/M-F	C,D,F	44	B
9:05pm	3hrs/M-F	A,C,D,F	45	B
10:05pm	3hrs/M-F	B,C,D,F	46	B
11:05pm	3hrs/M-F	A,B,C,D,F	47	B
12:05am midnight	3hrs/M-F	E,F	48	B

M-F = Monday through Friday

If the confirming number is incorrect, simply press the recorder's **MUTE** button to clear the code to zero, then re-enter the correct code. For further information on clearing codes see page 23.

To record **Two different 3 hour shows, Monday through Friday**, you can separate them into two different locations by using these quick setup codes along with the codes on page 15. Enter the **Quick setup code** of your choice.

Reference for setup:

Press **QUICK SETUP** button, Enter **Quick Code**, Check **Confirming #**, Press **QUICK SETUP** button, Press **RECORD** until light stays on.

START TIME	LENGTH/DAYS	QUICK CODE	CONF. #	EVENT LOCATION
1:05am	3hrs/M-F	A,E,F	49	C
2:05am	3hrs/M-F	B,E,F	50	C
3:05am	3hrs/M-F	A,B,E,F	51	C
4:05am	3hrs/M-F	C,E,F	52	C
5:05am	3hrs/M-F	A,C,E,F	53	C
6:05am	3hrs/M-F	B,C,E,F	54	C
7:05am	3hrs/M-F	A,B,C,E,F	55	C
8:05am	3hrs/M-F	D,E,F	56	C
9:05am	3hrs/M-F	A,D,E,F	57	C
10:05am	3hrs/M-F	B,D,E,F	58	C
11:05am	3hrs/M-F	A,B,D,E,F	59	C
12:05pm noon	3hrs/M-F	C,D,E,F	60	C
1:05pm	3hrs/M-F	A,C,D,E,F	61	C
2:05pm	3hrs/M-F	B,C,D,E,F	62	C
3:05pm	3hrs/M-F	A,B,C,D,E,F	63	C
4:05pm	3hrs/M-F	G	64	C
5:05pm	3hrs/M-F	A,G	65	C
6:05pm	3hrs/M-F	B,G	66	C
7:05pm	3hrs/M-F	A,B,G	67	C
8:05pm	3hrs/M-F	C,G	68	C
9:05pm	3hrs/M-F	A,C,G	69	C
10:05pm	3hrs/M-F	B,C,G	70	C
11:05pm	3hrs/M-F	A,B,C,G	71	C
12:05am midnight	3hrs/M-F	D,G	72	C

M-F = Monday through Friday

If the confirming number is incorrect, simply press the recorder's **MUTE** button to clear the code to zero, then re-enter the correct code. For further information on clearing codes see page 23.

If you wish to record the news **At the Top of Every Hour, Seven Days a Week** find the length of time you wish to record and enter the **Quick setup code** of your choice.

Reference for setup:

Press **QUICK SETUP** button, Enter **Quick Code**, Check **Confirming #**, Press **QUICK SETUP** button, Press **RECORD** until light stays on.

START TIME	LENGTH/DAYS	QUICK CODE	CONF. #	EVENT LOCATION
every hour	2min/All	A,D,F,IMMED	169	IMMED
every hour	3min/All	B,D,F,IMMED	170	IMMED
every hour	4min/All	A,B,D,F,IMMED	171	IMMED

With the previous **Quick Setup Codes**, the entire event was recorded into only one session letter code **A-G or IMMED**. The following lists record **One hour segments into multiple session letter codes**. (This makes it easier to select a particular hour of your favorite show you want to listen to.)

The following is a **5 hour** show.

HOST/SHOW	START TIME/DAY	QUICK CODE	CONF. #	EVENT LOCATION
Art Bell/Coast to Coast	7:05pm/M-F	B,C,E,F,IMMED	182	A,B,C,D,E
Art Bell/Coast to Coast	8:05 pm/M-F	A,B,C,E,F,IMMED	183	A,B,C,D,E
Art Bell/Coast to Coast	9:05 pm/M-F	B,D,E,F,IMMED	184	A,B,C,D,E
Art Bell/Coast to Coast	10:05 pm/M-F	A,D,E,F,IMMED	185	A,B,C,D,E
Art Bell/Coast to Coast	11:05 pm/M-F	B,D,E,F,IMMED	186	A,B,C,D,E
Art Bell/Coast to Coast	12:05 am/M-F	A,,D,E,F,IMMED	187	A,B,C,D,E
Art Bell/Coast to Coast	1:05 am/M-F	C,D,E,F,IMMED	188	A,B,C,D,E

M-F = Monday through Friday

If the confirming number is incorrect, simply press the recorder's **MUTE** button to clear the code to zero, then re-enter the correct code. For further information on clearing codes see page 23.

Use this page to find a **3 hour** time slot, **Seven Days a Week** you wish to record and enter the **Quick setup code** of your choice.

Reference for setup:

Press **QUICK SETUP** button, Enter **Quick Code**, Check **Confirming #**, Press **QUICK SETUP** button, Press **RECORD** until light stays on.

START TIME	LENGTH/DAYS	QUICK CODE	CONF. #	EVENT LOCATION
1:05am	3hrs/All	A,E,IMMED	145	G
2:05am	3hrs/All	B,E,IMMED	146	G
3:05am	3hrs/All	A,B,E,IMMED	147	G
4:05am	3hrs/All	C,E,IMMED	148	G
5:05am	3hrs/All	A,C,E,IMMED	149	G
6:05am	3hrs/All	B,C,E,IMMED	150	G
7:05am	3hrs/All	A,B,C,E,IMMED	151	G
8:05am	3hrs/All	D,E,IMMED	152	G
9:05am	3hrs/All	A,D,E,IMMED	153	G
10:05am	3hrs/All	B,D,E,IMMED	154	G
11:05am	3hrs/All	A,B,D,E,IMMED	155	G
12:05pm noon	3hrs/All	C,D,E,IMMED	156	G
1:05pm	3hrs/All	A,C,D,E,IMMED	157	G
2:05pm	3hrs/All	B,C,D,E,IMMED	158	G
3:05pm	3hrs/All	A,B,C,D,E,IMMED	159	G
4:05pm	3hrs/All	F,IMMED	160	G
5:05pm	3hrs/All	A,F,IMMED	161	G
6:05pm	3hrs/All	B,F,IMMED	162	G
7:05pm	3hrs/All	A,B,F,IMMED	163	G
8:05pm	3hrs/All	C,F,IMMED	164	G
9:05pm	3hrs/All	A,C,F,IMMED	165	G
10:05pm	3hrs/All	B,C,F,IMMED	166	G
11:05pm	3hrs/All	A,B,C,F,IMMED	167	G
12:05am midnight	3hrs/All	D,F,IMMED	168	G

All = Monday through Friday, Saturday and Sunday

If the confirming number is incorrect, simply press the recorder's **MUTE** button to clear the code to zero, then re-enter the correct code. For further information on clearing codes see page 23.

Use this page to find a **3 hour** time slot, **Saturday and Sunday** you wish to record and enter the **Quick setup code** of your choice.

Reference for setup:

Press **QUICK SETUP** button, Enter **Quick Code**, Check **Confirming #**, Press **QUICK SETUP** button, Press **RECORD** until light stays on.

START TIME	LENGTH/DAYS	QUICK CODE	CONF. #	EVENT LOCATION
1:05am	3hrs/S-S	A,D,G	73	D
2:05am	3hrs/S-S	B,D,G	74	D
3:05am	3hrs/S-S	A,B,D,G	75	D
4:05am	3hrs/S-S	C,D,G	76	D
5:05am	3hrs/S-S	A,C,D,G	77	D
6:05am	3hrs/S-S	B,C,D,G	78	D
7:05am	3hrs/S-S	A,B,C,D,G	79	D
8:05am	3hrs/S-S	E,G	80	D
9:05am	3hrs/S-S	A,E,G	81	D
10:05am	3hrs/S-S	B,E,G	82	D
11:05am	3hrs/S-S	A,B,E,G	83	D
12:05pm noon	3hrs/S-S	C,E,G	84	D
1:05pm	3hrs/S-S	A,E,G	85	D
2:05pm	3hrs/S-S	B,C,E,G	86	D
3:05pm	3hrs/S-S	A,B,C,E,G	87	D
4:05pm	3hrs/S-S	D,E,G	88	D
5:05pm	3hrs/S-S	A,D,E,G	89	D
6:05pm	3hrs/S-S	B,D,E,G	90	D
7:05pm	3hrs/S-S	A,B,D,E,G	91	D
8:05pm	3hrs/S-S	C,D,E,G	92	D
9:05pm	3hrs/S-S	A,C,D,E,G	93	D
10:05pm	3hrs/S-S	B,C,D,E,G	94	D
11:05pm	3hrs/S-S	A,B,C,D,E,G	95	D
12:05am midnight	3hrs/S-S	F,G	96	D

S-S = Saturday and Sunday

If the confirming number is incorrect, simply press the recorder's **MUTE** button to clear the code to zero, then re-enter the correct code. For further information on clearing codes see page 23.

Use this page to find a **3 hour** time slot, **Saturday only** you wish to record and enter the **Quick setup code of your choice**.

Reference for setup:

Press **QUICK SETUP** button, Enter **Quick Code**, Check **Confirming #**, Press **QUICK SETUP** button, Press **RECORD** until light stays on.

START TIME	LENGTH/DAYS	QUICK CODE	CONF. #	EVENT LOCATION
1:05am	3hrs/Sat	A,F,G	97	E
2:05am	3hrs/Sat	B,F,G	98	E
3:05am	3hrs/Sat	A,B,F,G	99	E
4:05am	3hrs/Sat	C,F,G	100	E
5:05am	3hrs/Sat	A,C,F,G	101	E
6:05am	3hrs/Sat	B,C,F,G	102	E
7:05am	3hrs/Sat	A,B,C,F,G	103	E
8:05am	3hrs/Sat	D,F,G	104	E
9:05am	3hrs/Sat	A,D,F,G	105	E
10:05am	3hrs/Sat	B,D,F,G	106	E
11:05am	3hrs/Sat	A,B,D,F,G	107	E
12:05pm noon	3hrs/Sat	C,D,F,G	108	E
1:05pm	3hrs/Sat	A,C,D,F,G	109	E
2:05pm	3hrs/Sat	B,C,D,F,G	110	E
3:05pm	3hrs/Sat	A,B,C,D,F,G	111	E
4:05pm	3hrs/Sat	E,F,G	112	E
5:05pm	3hrs/Sat	A,E,F,G	113	E
6:05pm	3hrs/Sat	B,E,F,G	114	E
7:05pm	3hrs/Sat	A,B,E,F,G	115	E
8:05pm	3hrs/Sat	C,E,F,G	116	E
9:05pm	3hrs/Sat	A,C,E,F,G	117	E
10:05pm	3hrs/Sat	B,C,E,F,G	118	E
11:05pm	3hrs/Sat	A,B,C,E,F,G	119	E
12:05am midnight	3hrs/Sat	D,E,F,G	120	E

Sat = Saturday only

If the confirming number is incorrect, simply press the recorder's **MUTE** button to clear the code to zero, then re-enter the correct code. For further information on clearing codes see page 23.

Use this page to find a **3 hour** time slot, **Sunday only** you wish to record and enter the **Quick setup code of your choice**.

Reference for setup:

Press **QUICK SETUP** button, Enter **Quick Code**, Check **Confirming #**, Press **QUICK SETUP** button, Press **RECORD** until light stays on.

START TIME	LENGTH/DAYS	QUICK CODE	CONF. #	EVENT LOCATION
1:05am	3hrs/Sun	A,D,E,F,G	121	F
2:05am	3hrs/Sun	B,D,E,F,G	122	F
3:05am	3hrs/Sun	A,B,D,E,F,G	123	F
4:05am	3hrs/Sun	C,D,E,F,G	124	F
5:05am	3hrs/Sun	A,C,D,E,F,G	125	F
6:05am	3hrs/Sun	B,C,D,E,F,G	126	F
7:05am	3hrs/Sun	A,B,C,D,E,F,G	127	F
8:05am	3hrs/Sun	IMMED	128	F
9:05am	3hrs/Sun	A,IMMED	129	F
10:05am	3hrs/Sun	B,IMMED	130	F
11:05am	3hrs/Sun	A,B,IMMED	131	F
12:05pm noon	3hrs/Sun	C,IMMED	132	F
1:05pm	3hrs/Sun	A,C,IMMED	133	F
2:05pm	3hrs/Sun	B,C,IMMED	134	F
3:05pm	3hrs/Sun	A,B,C,IMMED	135	F
4:05pm	3hrs/Sun	D,IMMED	136	F
5:05pm	3hrs/Sun	A,D,IMMED	137	F
6:05pm	3hrs/Sun	B,D,IMMED	138	F
7:05pm	3hrs/Sun	A,B,D,IMMED	139	F
8:05pm	3hrs/Sun	C,D,IMMED	140	F
9:05pm	3hrs/Sun	A,C,D,IMMED	141	F
10:05pm	3hrs/Sun	B,C,D,IMMED	142	F
11:05pm	3hrs/Sun	A,B,C,D,IMMED	143	F
12:05am midnight	3hrs/Sun	E,IMMED	144	F

Sun = Sunday only

If the confirming number is incorrect, simply press the recorder's **MUTE** button to clear the code to zero, then re-enter the correct code. For further information on clearing codes see page 23.