

C.C.CRANE

CC SOLAR OBSERVER



INSTRUCTION MANUAL

Please read all the instructions completely before use and save this manual for future reference.

This page left blank intentionally.

UNPACKING

The box should contain the CC Pocket Radio, earbuds, FM wire antenna, and this manual. If anything is missing or damaged please contact C. Crane immediately. We recommend you keep the box in the unlikely event your radio needs to be serviced.

FOR YOUR FUTURE REFERENCE:

Serial No. (Found inside battery compartment):

Date of purchase/Name & address of dealer:

Safety Instructions

WARNING: To prevent fire or electric shock hazard do not expose this product to rain or moisture.

CAUTION

RISK OF ELECTRIC SHOCK. DO NOT OPEN.

CAUTION: To reduce the risk of electric shock, do not remove the radio back. No user serviceable parts inside. Refer servicing to qualified service personnel.



THE LIGHTNING FLASH AND ARROWHEAD WITHIN THE TRIANGLE IS A WARNING SIGN ALERTING YOU OF “DANGEROUS VOLTAGE” INSIDE THE RADIO.



THE EXCLAMATION POINT WITHIN THE TRIANGLE IS A WARNING SIGN ALERTING YOU OF IMPORTANT INSTRUCTIONS ACCOMPANYING THIS RADIO.

PLEASE READ BEFORE USING THE RADIO

- The internal battery pack will need to be fully charged and fully depleted three consecutive times to build maximum battery life.
- If you plan to use the optional AC adapter for more than 12 hours, disconnect the internal battery pack to avoid overcharging it.

Safety Instructions

- If you need to use the phone charger port, do not connect the AC adapter at the same time to avoid damage to the AC adapter or cause phone battery discharge.
- We recommend the internal battery pack to be fully depleted and fully recharged every 6 months if the radio has not been used. This will help maintain optimal battery life.
- Keep these precautions and instructions where all who will use this radio will read them.
- Before turning the unit on, set your volume control to a low setting.
- Slowly increase the sound until you can hear it comfortably and clearly without distortion.
- Long-term exposure to loud sounds may cause hearing damage.



It is best to avoid high volume levels when using headphones/earbuds, especially for extended periods.

Safety Instructions



READ BEFORE OPERATING EQUIPMENT SAVE THESE INSTRUCTIONS



To prevent damage to your radio or possible injury to you or others, read these safety precautions and instructions entirely before applying power to the radio. Keep these precautions/instructions where all who use this radio will read them.

1) COMMON CARE ⚠

Check the radio and any accessories regularly. Do not use the radio if there is any sign of damage. Only operate in accordance with the instructions in this manual. Only use attachments or accessories specified by C. Crane.

NOTE: If the radio is unused for more than 6 months, we recommend winding the crank for at least 30 seconds to keep the battery healthy. Thereafter we recommend charging the battery fully before returning to storage.

2) DISCONNECT THE RADIO IN CASE OF MALFUNCTION ⚠

If you smell or notice smoke, disconnect the optional AC Adapter immediately, taking care to avoid burns. Please contact C. Crane for inspection and service before any future operation. Only use the AC-DC Adapter recommended with the unit and replace it if any wires become frayed or exposed. It should have an output of 5 Volts 300mA DC. Use only the recommended adapter. Otherwise it may damage the radio or cause a fire or electric shock.

Safety Instructions

3) KEEP OUT OF REACH OF CHILDREN ⚠

Dropping the radio can cause damage or injury. Keep the AC Adapter cord in a position so someone cannot trip and cause the radio to fall.

4) KEEP AWAY FROM WATER AND MOISTURE ⚠

Keep the radio dry. Liquids and moisture can damage the radio. If a liquid leaks into the radio do not operate and seek a qualified service shop.

5) KEEP AWAY FROM EXTREME TEMPERATURES ⚠

Extreme temperatures can damage the radio. Do not leave or use the radio where it can be subjected to high temperatures such as the inside of a car.

CAUTION: Some windows may intensify the sun's effect on your radio, causing melting or a potential fire hazard.

6) DO NOT ATTEMPT TO SERVICE RADIO ⚠

Refer all service work to a qualified service shop when the radio does not appear to operate normally, exhibits a change in performance or the radio has received damage. Never open the radio as this may expose you to dangerous voltages and this will void all warranties.

7) OUTSIDE ANTENNAS OR CABLES ⚠

Outside antennas or cables that create a potential hazard should not be used with this radio unless installed by qualified personnel.

This page left blank intentionally.

Table of Contents

Unpacking / Owners Record _____	03
Safety Instructions _____	04
Radio Controls and Functions _____	10

Getting Started

Powering Your Radio _____	12
Inserting the Batteries _____	13

Radio Operation

Tuning _____	15
Volume Control _____	15
Display Light _____	15
Flashlight _____	15
Headphone Jack _____	16
Phone Charger Jack _____	16

Specifications _____	17
----------------------	----

Troubleshooting Guide _____	19
-----------------------------	----

Personal Station Log _____	21
----------------------------	----

Radio Controls and Functions

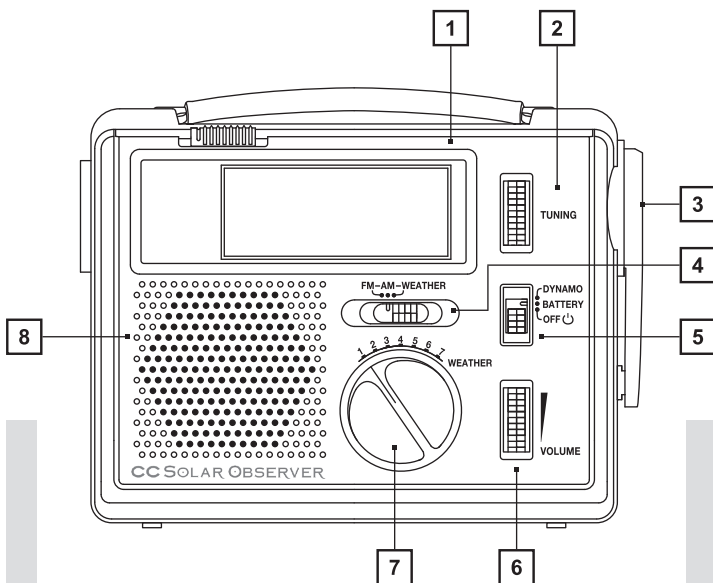

1) DISPLAY PANEL

2) TUNING DIAL

3) DYNAMO CRANK

4) BAND SWITCH

5) POWER SELECTION SWITCH

6) VOLUME CONTROL

7) WEATHER DIAL

8) SPEAKER

Radio Controls and Functions

Left Side

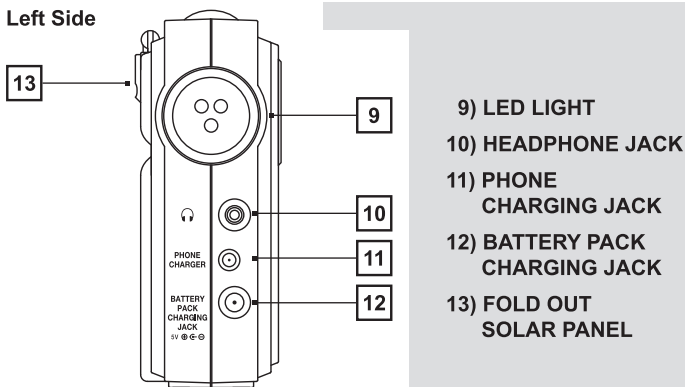

Top of Radio

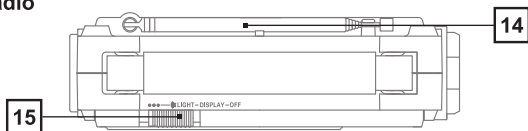

Display

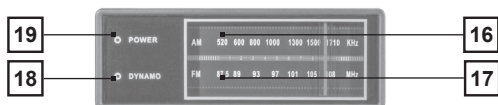

Power Options

POWER USING THE SOLAR PANEL

Place the solar panel in direct sunlight. It is best to angle the solar panel so that it is pointed directly at the sun. The solar panel is hinged to allow for better positioning. Do not charge the radio in a hot area like a car. To charge the internal battery pack with the solar panel, it is best to leave the radio turned off. Eight hours of direct sunlight should provide 4 to 6 hours of playtime at medium volume, depending on the sun intensity. Set the “Power Switch” to “Dynamo” to play. Takes approximately 30 hours of full sun to fully charge the battery pack. A fully charged battery pack will provide approximately 15-20 hours of playtime depending on your volume level.

POWER BY WINDING

Unfold the Dynamo Crank (labeled ‘Power Generator’) from the side of the radio and rotate in either direction. The green “DYNAMO” light on the front of the radio will glow indicating proper winding speed. After 90 seconds of winding the radio will play for about 15 to 25 minutes. This varies depending on the winding speed, volume level and band selection.

POWER USING “AA” BATTERIES

When using “AA” alkaline batteries the radio should play at normal volume for about 60 hours. It is possible to use fully charged nickel metal hydride rechargeable “AA” batteries instead of alkaline, however, you will have less playtime.

Power Options

INSERTING THE BATTERIES

- 1) Position the radio face down on a soft surface to protect it.
- 2) Gently press and slide the battery compartment cover towards you. It will slide down slightly, and then flips up on its hinges. Do not force.
- 3) Insert the 3 “AA” batteries into the compartment, as indicated in the picture below. Be sure the negative (-) end is against the spring. Refer to the picture below to ensure correct installation of your batteries.
- 4) Place the battery cover down flat and slide back up to the closed position. On the front of the radio, slide the “Power Switch” to “Battery” to turn the radio on.

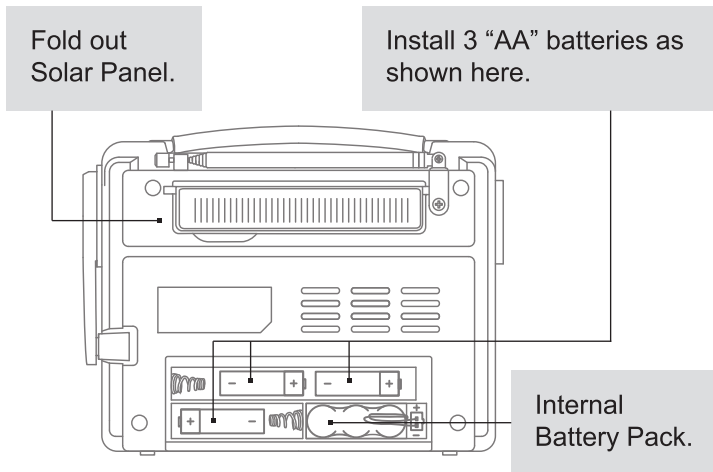

Power Options

POWER BY CHARGING ADAPTER (OPTIONAL ACCESSORY NOT INCLUDED)

Connect the AC charging adapter between a 120 Volt/60 Hz wall outlet and the “BATTERY PACK CHARGING JACK” on the side of the radio. The green “DYNAMO” light will glow.

To fully charge the battery pack, plug the charging adapter in. We recommend keeping it plugged in for no more than 12 hours.

NOTE: The AC charging adapter should only be used to charge the battery pack and should not be used to power the radio on a constant basis. Leaving the charging adapter plugged into the radio for long periods of time will shorten the life of the internal battery pack (See Page 4).

NOTE: We do not recommend using the AC charging adapter while your cell phone is connected to the radio. Many newer cell phones require more power than the power adapter can supply. This can cause the cell phone to discharge and possibly damage the power adapter.

Radio Operation

TUNING

The CC Solar Observer features three bands: FM, AM and WEATHER.

- 1) Position the power switch to “BATTERY” or “DYNAMO”.
- 2) Select band by positioning the “BAND SWITCH”.
- 3) Adjust TUNING dial to desired frequency. For tuning Weather, position the “WEATHER” dial to the desired channel (1 through 7).

VOLUME CONTROL

Rotate to adjust volume

DISPLAY LIGHT

To turn the display light on, move the light switch to the “DISPLAY” position (see Top of Radio diagram on **Page 11**). The display light will remain on until you turn it off.

FLASHLIGHT

Located on the left side of the CC Solar Observer is a flashlight consisting of three bright LEDs (see Side of Radio diagram on **Page 11**). To turn the flashlight on move the light switch to the “LIGHT” position. The special LED bulbs last more than 10,000 hours and use very little electrical energy.

Radio Operation

HEADPHONE JACK

You can use stereo or mono headphones with a 1/8" (3.5mm) plug. When you insert the headphone plug, the speaker is disconnected.

PHONE CHARGER JACK

In an emergency, you may need to power your cell phone to make an important call. Cranking the radio for just 90 seconds should give you enough time to make a few quick calls. This of course will depend on the make and model of your cell phone. Attach the included Radio-to-USB Adapter to your cell phone's USB charging cable (not included), then plug it into the jack on the radio labeled "PHONE CHARGER". If you do not have a USB charging cable for your cell phone, you can usually purchase one from your cell phone provider.



Your phone will start charging as soon as you plug it into the radio. If the CC Solar Observer is fully charged, it will charge your cell phone battery for about 20-40 minutes. If the Observer's batteries are low or dead, a message may appear on your phone saying the charger is incompatible.

NOTE: Do not use the optional AC Charging Adapter when charging your cell phone.

Specifications

FREQUENCY COVERAGE:

FM Band: 87.50 - 108 MHz Stereo

AM Band: 520 - 1710 kHz

WX Band: 162.400 - 162.550 MHz

POWER SOURCE:

- Batteries: 3 “AA” size (**NOTE:** Do not use Lithium batteries)
 - Internal Battery Pack: NiMH 2/3 “AA” 800 mAh
 - Battery Pack Charging Jack: Internal Battery Pack can be charged with optional
 - AC Adapter - 5V 300 mA DC
 - Winding Generator: 300-500 mA (DC depending on RPM)
 - Solar Panel: 20-40 mA DC (Depending on sunlight intensity)
-

POWER CONSUMPTION AT MODERATE VOLUME:

AM: 38 mA

Flashlight: 23 mA

FM: 45 mA

Display Light: 5 mA

Weather: 45 mA

AUDIO:

Speaker: 2.5”

ANTENNA:

FM and Weather Band: Telescopic whip antenna

AM Band: Built-in Ferrite Bar

Specifications

WEIGHT AND DIMENSIONS:

Weight: 1 lb.

Dimensions: 7.25" W x 5.5" H x 2" D

HEADPHONE JACK:

1/8" (3.5 mm) - Will accept stereo or mono plug.

WARRANTY:

1 Year Limited Warranty

NOTE: Specifications are subject to change without notice.

Troubleshooting Guide

MY CC SOLAR OBSERVER WAS WORKING BUT NOW I HAVE NO AM/FM/WX BUT THE LED FUNCTIONS WORK. HOW COME?

In some cases, if your radio is left on for an extended amount of time after the battery pack is fully depleted, the microprocessor inside the radio may have locked up and disabled the radio functions. It will be necessary to unplug the battery pack, remove any “AA” batteries and cover the solar panel for 15 minutes (or place the radio in a dark area). This will allow a reset of the processor.

Re-insert the battery pack and “AA” batteries (if desired), then using the hand crank, wind the radio at a good pace for 90 seconds and then try the radio functions.

WHY IS THE SOUND GARBLED ON MY CC SOLAR OBSERVER? HOW CAN I FIX IT?

The rechargeable battery pack may be depleted. Charging the unit for a few minutes should clear up the sound.

HOW DO I GET THE BEST RUNTIME ON MY CC SOLAR OBSERVER?

The simple answer is to “exercise” the batteries to condition them for an optimal charge. To do this, charge the batteries to full and then discharge them completely. Performing this procedure about 3 times will bring your batteries to optimal efficiency.

CAN “AA” LITHIUM BATTERIES BE USED IN THE CC SOLAR OBSERVER?

No. Lithium batteries can damage the radio.

CAN I CHARGE MY CELL PHONE WHILE CHARGING MY CC SOLAR OBSERVER RADIO USING THE AC ADAPTER?

No. We do not recommend having the AC Adapter connected to the radio while charging your cell phone or other devices.

WHEN I TRY USING THE DYNAMO CRANK TO CHARGE THE INTERNAL BATTERY PACK, IT IS VERY HARD TO TURN THE CRANK.

Hard winding of the Dynamo Crank on the CC Solar Observer is usually due to a low charge on the internal battery pack. For best results, continue winding the Dynamo Crank and try winding at a rate of two full turns per second.

Another option is to use the optional AC Charging Adapter (sold separately) to fully charge the internal battery pack.

PERSONAL STATION LOG

City	Station Call Letters	Frequency	Date & Time

Please feel free to copy this page.

PERSONAL STATION LOG

City	Station Call Letters	Frequency	Date & Time

Please feel free to copy this page.

This page left blank intentionally.

MODEL: CC SOLAR OBSERVER

ANSI C63.4: 2003

THIS DEVICE COMPLIES WITH PART 15 OF THE FCC RULES. OPERATION IS SUBJECT TO THE FOLLOWING TWO CONDITIONS:

- 1) THIS DEVICE MAY NOT CAUSE HARMFUL INTERFERENCE, AND
- 2) THIS DEVICE MUST ACCEPT ANY INTERFERENCE RECEIVED, INCLUDING INTERFERENCE THAT MAY CAUSE UNDESIRE OPERATION.

NOTICE: Any changes or modifications not expressly approved by the party responsible for compliance could void the users authority to operate the equipment.

C.CRANE

172 Main Street

Fortuna, CA 95540-1816

Phone: 1-800-522-8863 | Web: ccrane.com

Copyright © 2022 by C. Crane. All rights reserved. No part of this booklet may be reproduced, in any form or means whatsoever, without permission in writing from C. Crane. V1