

C.CRANE

FM REFLECT - 2

FM DIPOLE ANTENNA

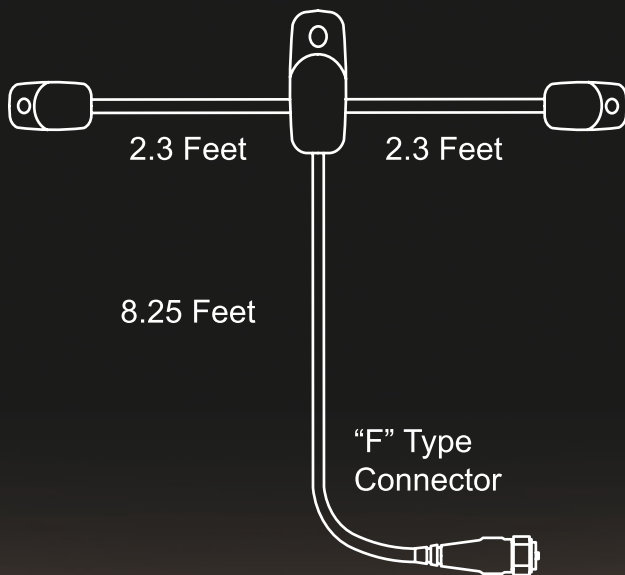

**Works with all Portable,
Tabletop and Home Stereos.**

Made in China

FM Reflect-2 Antenna



UNPACKING

This bag should contain the FM Reflect 2 with Female “F” Connector, Male “F” Connector x 1/8” (3.5mm) Mono Adapter, Balun Spade Connector Adapter and Alligator Clip Adapter.

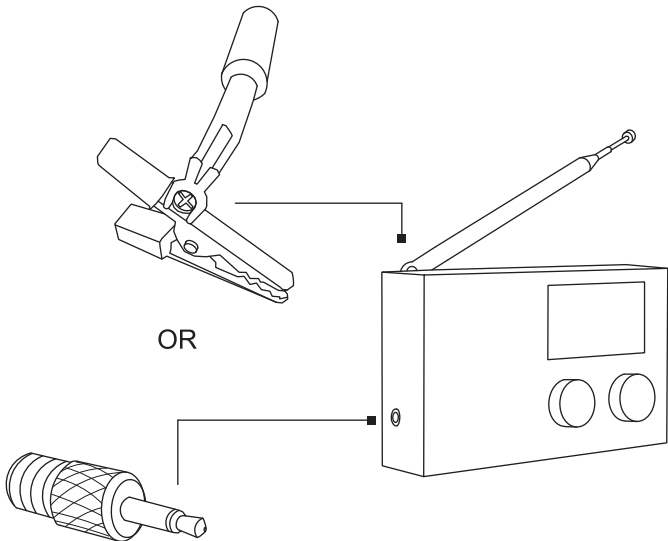

FREE ADAPTERS INCLUDED

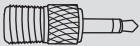

Male “F” Connector x 1/8”
(3.5mm) Mono Adapter

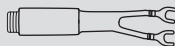

Balun Spade
Connector Adapter

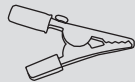

Alligator
Clip Adapter

ORIENTATION

- 1) Traditional orientation.
- 2) Unconventional, but may work best. Mount high if possible.
- 3) May work better for Circular Polarization. Most stations use this.

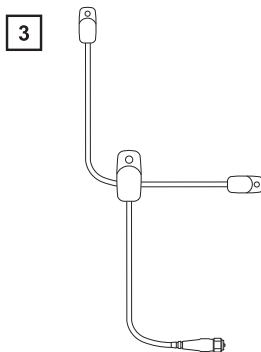
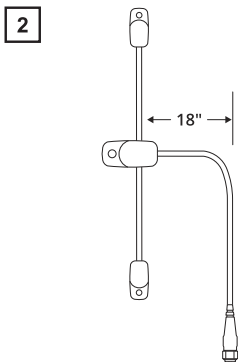
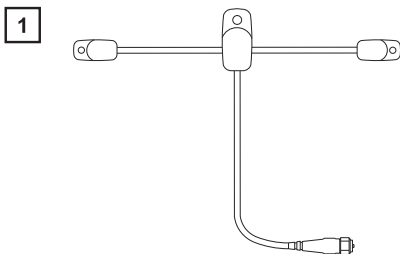

FM ANTENNA TIPS: Experimentation may be necessary to find the best location and orientation. Usually higher is better.

MAXIMUM FM RECEPTION

- **As good as or better than a standard dipole and it is easier to install.**
- **Works well with standard and HD Radio.**
- **Easy to Install.**

C.CRANE

172 Main Street

Fortuna, CA 95540-1816

1-800-522-8863 | ccrane.com

© 2022 C. Crane. All rights reserved.

