

# C.C.CRANE

## Point-to-Point Antenna - Assembly Guide

Contents:

**A**



Grid Reflector

**B**

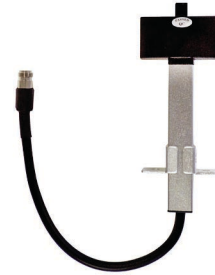

Feed Horn

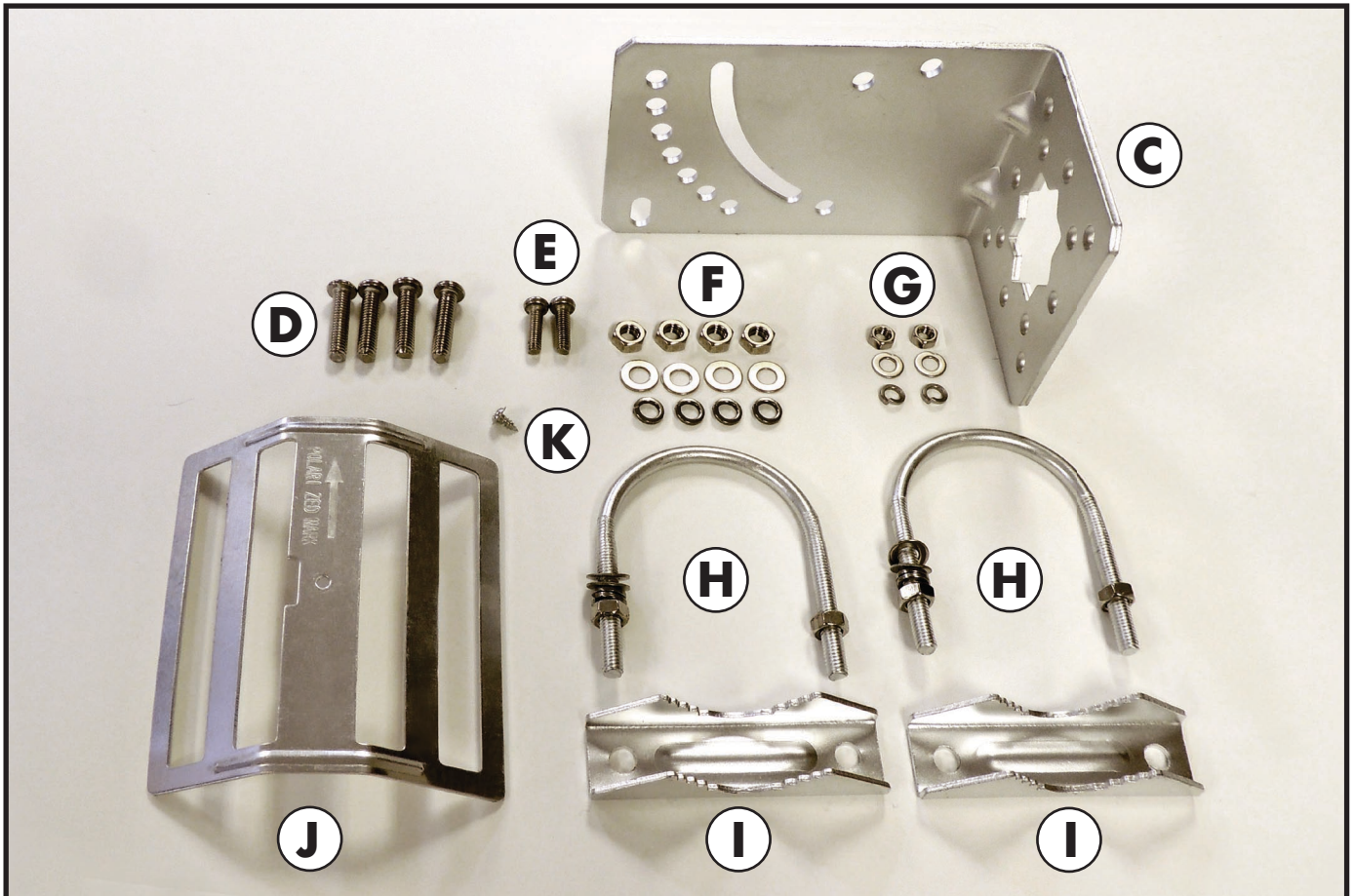

- C** 'L' Bracket    **D** 4 - Large Screw-bolt    **E** 2- Small Screw-bolt  
**F** 4- Large nut with flat washer and lock washer    **G** 2- Small nut with flat washer and lock washer  
**H** 2- U-Bolts with nuts, flat washers, and lock washers    **I** 2- Pole bracket clamps  
**J** 1- Small Reflector    **K** 1- Small Reflector screw

# Point-to-Point Antenna - Assembly Guide

## 1. Assemble Grid Reflector

-Fit two halves together and use the (2) small screw-bolts: (E) and the (2) small nuts with flat and lock-washers: (G) to secure

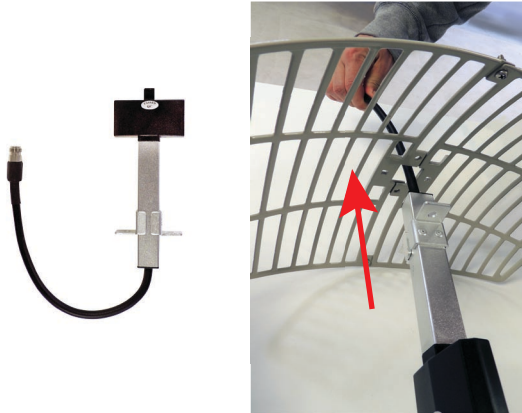
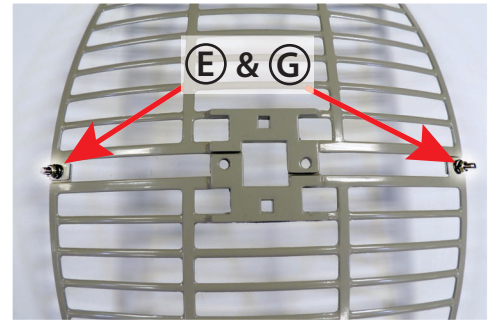

## 2. Connect Feed Horn to Reflector

-Route coax cable connected to feed horn through front middle square hole, lining-up the round holes on the feed horn and the grid reflector.

## 3. Attach 'L' Bracket, Grid Reflector, and Feed Horn together.

-Before inserting screws line up holes for all 3 pieces, connecting all 3 together using the (4) Large screw-bolts: (D) large nuts with flat and lock-washers: (F)

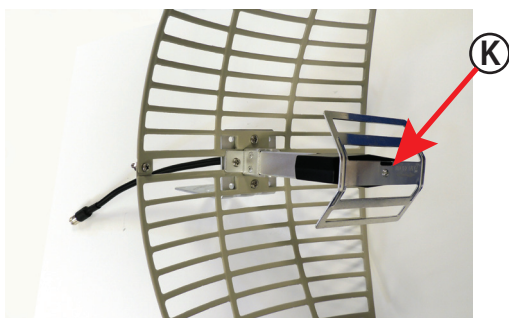
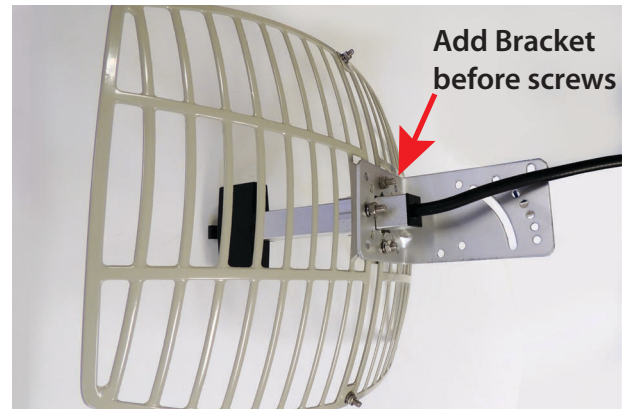

## 4. Attach Small Reflector

-This will fit only one way. Align and insert the small screw: (K)

## 5. Attach Antenna to Pole

(Mounting bracket can accommodate 1.25" to 2.2" pole.)

- Place U-Bolts around pole
- Attach Bracket Mounts
- Attach 'L' Bracket (Follow picture for flat mounting. For angle mounting use just 1 U-Bolt and indicated holes.)
- Secure with the attached washers, lock washers and nuts

